

MATERIAL NUMBER	ENGINEERING NUMBER	CARRIER	TAB THICKNESS	LOGO ORIENTATION
197084003	19708-4003	STRIP	.020/0.51	IN
197084013	19708-4013	STRIP	.032/0.81	
197084015	19708-4015	STRIP	.032/0.81	
197084001	19708-4001	LOOSE	.020/0.51	-
197084011	19708-4011	LOOSE	.032/0.81	-

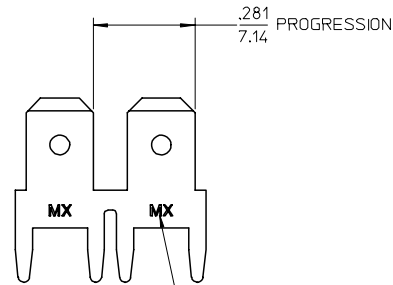

LOGO OPTIONS:
MX, ETC. OR MX-ETC

RECOMMENDED PCB
HOLE LAYOUT

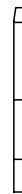
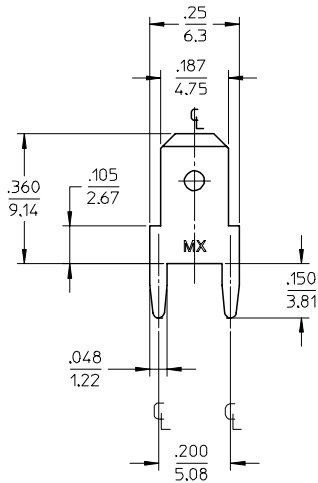
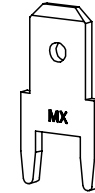
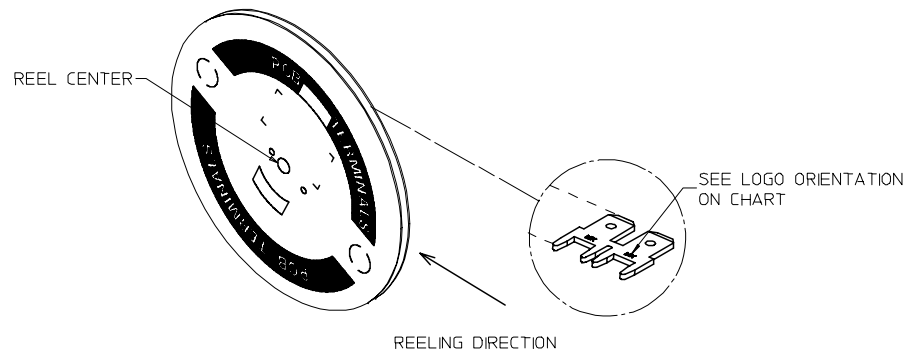
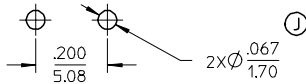

NOTES:

1. BARE EDGES PERMISSIBLE AT CARRIER CUT OFF.
2. MATERIAL: BRASS C26000
3. MATERIAL THICKNESS: SEE CHART
4. TAB CONFORMS TO NEMA SPECIFICATIONS.
5. ALL DIMENSIONS AND NOTES REFERENCE UNLESS OTHERWISE NOTED.
6. PLATING: MATTE TIN, 150μIN/3.81μmm MINIMUM THICKNESS OVER NICKEL 50μIN/1.25μmm MINIMUM THICKNESS.
7. REF.: 15,000 MINIMUM PARTS PER REEL, REEL HAS 14" DIAMETER REEL WITH A 1.25" DIAMETER CENTER HOLE.
8. PART IS ROHS COMPLIANT.

ADD LOOSE PC - REV PCB HOLE EC NO: ETC2007-0403 DRAWN BY: DRWNEHLE CHKD: JMAGNELL APPR: JMAGNELL 2007/05/14 2007/05/14 2007/05/15	QUALITY SYMBOLS ▽=0 ▽=0	GENERAL TOLERANCES (UNLESS SPECIFIED)		DIMENSION STYLE IN/MM		SCALE 4:1	DESIGN UNITS INCH	THIRD ANGLE PROJECTION			
		4 PLACES ± --- ± ---	mm INCH	DRAWN BY JH	DATE 10/18/96	TITLE QUICK DISCONNECT PCB MOUNTABLE .187 X .032/.020 TAB					
		3 PLACES ± --- ± .005	± .005 ± .01	CHECKED BY RWD	DATE 10/18/96	MOLEX INCORPORATED					
		2 PLACES ± 0.13 ± .01	± .01 ± ---	APPROVED BY RWD	DATE 10/18/96	MATERIAL NO. SD-19708-400 DOCUMENT NO. SHEET NO. 1 OF 1					
1 PLACE ± 0.25 ± ---		ANGULAR ± 1 °		SEE CHART		THIS DRAWING CONTAINS INFORMATION THAT IS PROPRIETARY TO MOLEX INCORPORATED AND SHOULD NOT BE USED WITHOUT WRITTEN PERMISSION					