

PART NUMBER	REV	FIRST USED
466877-2	E	565435-5

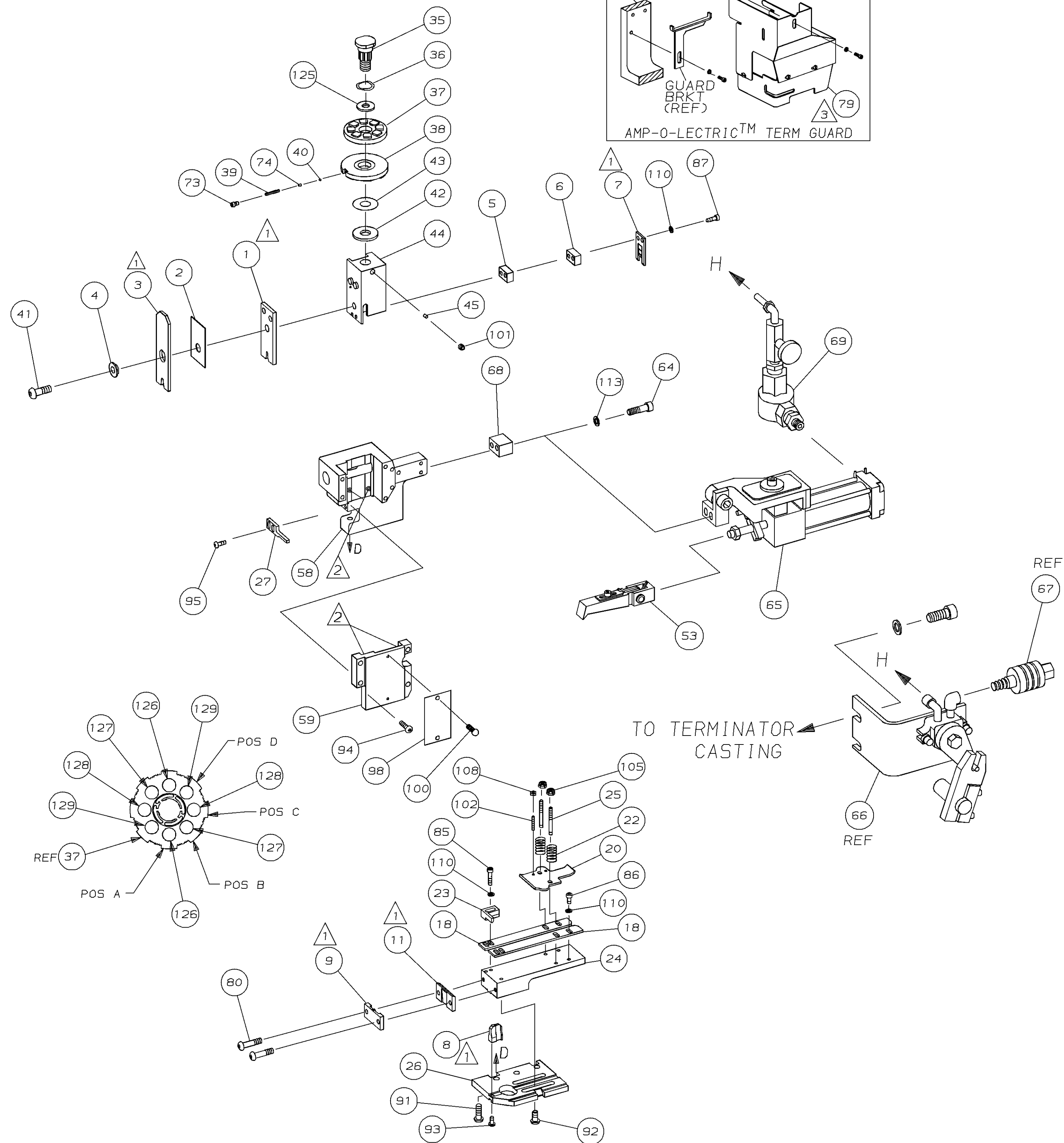
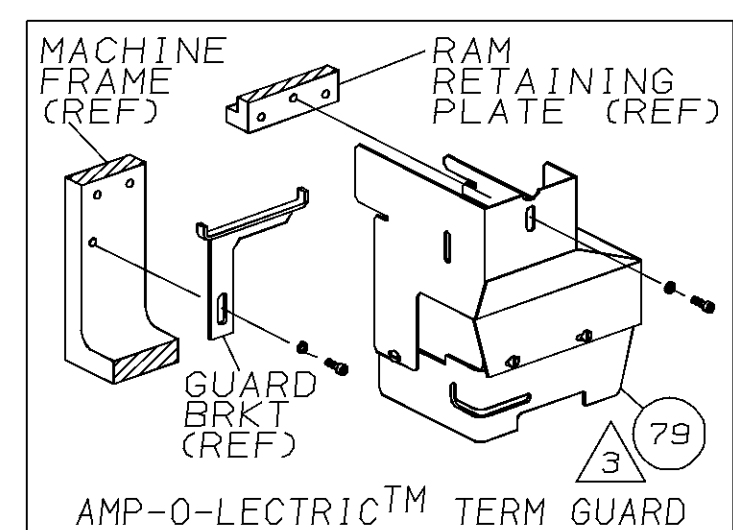

- ① RECOMMENDED SPARE PARTS.
- ② GREASE LIGHTLY.
- ③ GUARD MUST BE IN PLACE WHEN OPERATING APPLICATOR IN A BENCH MACHINE.
- ④ SEE DRAWING FOR COMPONENTS.
- ⑤ CUT TO LENGTH AT ASSEMBLY.

TERMINAL NAME: .375 FASTIN-FASTON™ TAB					
280074		CRIMPING DATA			
PAD LTR	CRIMP HEIGHT	WIRE SIZE			
A	.121 ±.002 [3.07 ±0.05mm]	7			
B	.114 ±.002 [2.9 ±0.05mm]	8			
C	.105 ±.002 [2.67 ±0.05mm]	9			
D	.098 ±.002 [2.49 ±0.05mm]	10			
CRIMP	SIZE	TYPE	RANGE		
WIRE	.250 [6.35mm]	F	10-7		
INSUL	.320 [8.13mm]	0	.200-.275		
WIRE STRIP LENGTH	TERM APPL SPEC	FEED	APPL INSTRUCTION	SET UP GAGE	LAYOUT
-	114-0021	1.550	408-8039	458638-1	1110

QTY	REV	DESCRIPTION	ITEM NO
2	-	C 8-354778-5 PIN, WIRE DISC (.2920)D	129
2	-	C 7-354778-1 PIN, WIRE DISC (.2850)C	128
2	-	C 5-354778-3 PIN, WIRE DISC (.2760)B	127
2	-	C 3-354778-9 PIN, WIRE DISC (.2690)A	126
1	-	A 986950-1 WASHER, FLAT PRECISION	125
			124
			123
			122
			121
			120
			119
			118
			117
			116
			115
			114
2	-	A 21024-5 WASHER, LOCK (#10) AIR ASSY	113
			112
7	-	A 21024-4 WASHER, LOCK (NO. 8) SHEAR BL	111
			110
2	-	A 21018-4 NUT, HEX (4-40) DRAG	108
			107
			106
2	-	A 21022-2 NUT, HEX SL (8-32) DRAG STUD	105
			104
			103
2	-	A 2-21006-6 SCR, SKT SET (4-40x.62) DRAG	102
1	-	A 21009-2 SCR, SKT SET (1/4-20x.25) RAM	101
2	-	A 21017-2 SCR, DRIVE (#2x.19) ID PLATE	100
			99
1	-	B 461264-1 PLATE, IDENTIFICATION	98
			97
			96
2	-	A 2-21002-2 SCR, BHC (8-32x.50) STRIPPER	95
4	-	A 2-21002-9 SCR, BHC (10-32x.75) CAP	94
1	-	A 22733-8 SCR, BHC (8-32x.38 LW) ANVIL	93
4	-	A 3-21002-3 SCR, BHC (1/4-20x.50) ST 6D PL	92
3	-	A 2-22733-8 SCR, BHC (1/4-20x.62) HSG	91
			90
			89
			88
2	-	A 3-21000-2 SCR, SHC (8-32x1.16) SLUG BLADE	87
3	-	A 2-21000-6 SCR, SHC (8-32x.38) STRIP GUIDE	86
2	-	A 2-21000-9 SCR, SHC (8-32x.75) R STRIP GUIDE	85
			84
			83
			82
			81
2	-	A 3-21002-0 SCR, BHC (10-32x.88) SHEAR PL	80
1	-	A 455750-7 GUARD ASSY	79
			78
			77
			76
			75
1	-	A 690603-1 SPRING, ASSIST	74
1	-	A 23030-1 SCR, SKT CAP (6-32x.25) CP DSC	73
			72
			71

QTY REQD PER ASSY	U/M	DWG SIZE	PART NO	DESCRIPTION	ITEM NO

QTY	REV	DESCRIPTION	ITEM NO
1	-	C 692655-5 AIR FEED VALVE ASSY	70
1	-	A 461690-1 SPACER, AIR FEED	69
REF	-	A 24042-2 VALVE, SHUT OFF	67
REF	-	C 692655-6 AIR FEED VALVE ASSY	66
1	-	B 1-460277-5 AIR FEED ASSY (2 INCH)	65
2	-	A 4-21000-3 SCR, SHC (10-32x2.00) AIR ASSY	64
			63
			62
			61
			60
1	-	C 454220-1 CAP, RAM	59
1	-	D 453736-1 HOUSING	58
			57
			56
			55
			54
1	-	B 460680-2 FEED FINGER ASSY	53
			52
			51
			50
			49
			48
			47
			46
1	-	A 690191-1 PLUG, NYLON	45
1	-	C 455674-1 RAM	44
1	-	A 690125-1 WASHER, LAMINATED	43
1	-	A 1-690124-0 WASHER, RAM	42
1	-	A 690686-1 BOLT, CRIMPER (5/16-24x1.00)	41
1	-	A 23241-6 BALL, STEEL	40
1	-	A 690170-1 SPRING, COMPRESSION	39
1	-	C 690142-1 DISC, INSULATION	38
1	-	D 354777-1 WIRE DISC, PLASTIC	37
1	-	A 22480-5 WASHER, SPRING	36
1	-	B 690212-1 POST, RAM	35
			34
			33
			32
			31
			30
			29
			28
1	-	A 690455-3 STRIPPER	27
1	-	D 455676-2 PLATE, BASE	26
2	-	A 22354-9 DRAG, STUD	25
1	-	B 455678-3 PLATE, STRIP GUIDE	24
1	-	C 240825-5 PLATE, STRIP HOLD DOWN	23
2	-	A 4-22281-1 SPRING, DRAG	22
			21
1	-	A 454177-1 DRAG, STOCK	20
			19
2	-	C 1-454204-0 GUIDE, STRIP (FRONT)	18
			17
			16
			15
			14
			13
			12
1	-	B 240644-5 PLATE, REAR SHEAR	11
			10
1	-	B 1-690482-8 PLATE, FRONT SHEAR	9
1	-	D 683452-2 ANVIL	8
1	-	B 3-690474-6 BLADE, SLUG	7
1	-	C 5-240641-3 SPACER, SLUG BLADE	6
1	-	C 5-240641-6 SPACER, SLUG BLADE	5
1	-	B 238009-3 SPACER, BLOCK CRIMPER	4
1	-	C 683454-3 CRIMPER, INSULATION	3
1	-	B 1-455888-2 SPACER, CRIMPER	2
1	-	C 456432-2 CRIMPER, WIRE	1

QTY REQD PER ASSY	U/M	DWG SIZE	PART NO	DESCRIPTION	ITEM NO

LOC A
DIST 66

DIMENSIONS IN INCHES. DO NOT SCALE PRINT. TOLERANCES UNLESS OTHERWISE SPECIFIED:
 2 PLC DEC ±.25
 3 PLC DEC ±.
 4 PLC DEC ±.
 ANGLES ±.
 REMOVE BURRS, BREAK SHARP EDGES R.015 MAX

MATL - HT TR - FIN -

DR D.SALTZER 11-1-95 APP T.BEDDICK 11-14-95
 CHK 11-14-95 REL 11/16/95
 C.ERISMAN B. MORGAN

NAME END FEED HDM APPLICATOR MACHINE REF MINI APPL
 SCALE - DWG NO 466877 SHEET 1 OF 1 REV E

THIS DRAWING IS A CONTROLLED DOCUMENT FOR AMP INCORPORATED. IT IS SUBJECT TO CHANGE AND THE CONTROLLING ENGINEERING ORGANIZATION SHOULD BE CONTACTED FOR THE LATEST REVISION.

THIS INFORMATION IS CONFIDENTIAL AND IS DISCLOSED TO YOU ON CONDITION THAT NO FURTHER DISCLOSURE IS MADE BY YOU TO OTHER THAN AMP PERSONNEL WITHOUT WRITTEN AUTHORIZATION FROM AMP INCORPORATED, HARRISBURG, PA.