

NOTES:  
 1- ONLY THE ITEMS WITH QUANTITIES SPECIFIED ON PARTS LIST ARE USED ON THIS APPLICATOR.  
 2- USED IN PLACE OF ITEM 38 WHEN INSULATION CRIMP IS NOT USED.  
 3- GUARD MUST BE IN PLACE WHEN OPERATING APPLICATOR IN AMP-O-LECTRIC PRESS.  
 4. PARTS WITH QTY OF REF. SPECIFIED (EXCEPT ITEM 79) ARE USED ON ITEM 4G.

KEY:  
 ■ RECOMMENDED SPARE PARTS CUSTOMER RESPONSIBLE FOR REPLACEMENT.  
 ▲ LUBRICATE DAILY USING NO. 20 MACHINE OIL.  
 ● GREASE LIGHTLY

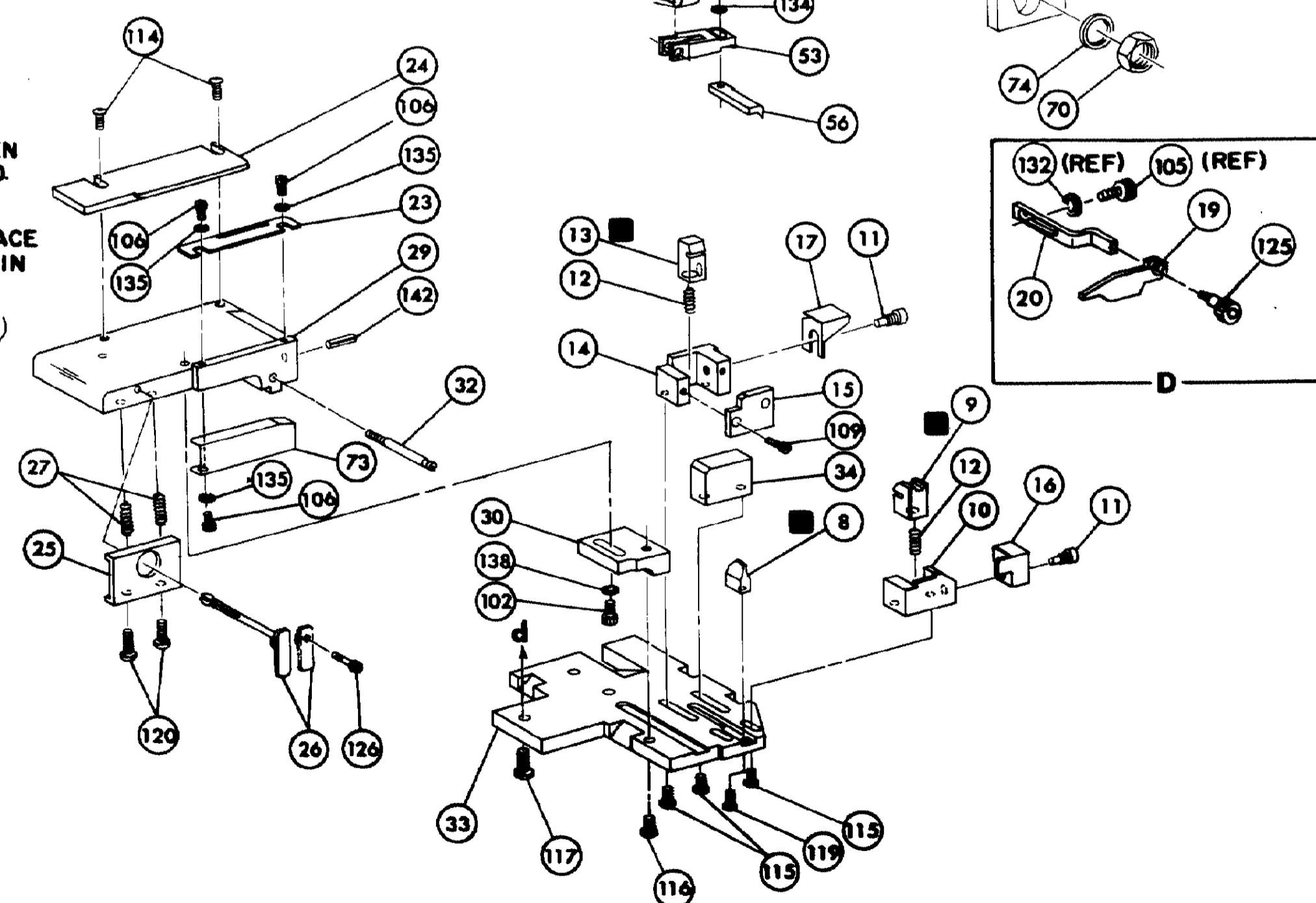

REF.	DESCRIPTION	QTY	REF.	DESCRIPTION	QTY
21045-3	RING, RETAINING 'C' (.187 DIA) FEED FINGER PIN	145	454220-1	CAP, HOUSING	59
5-21028-1	PIN, SLOT SPR (.125 DIA X .50) ADJ ROD	143	454485-1	HOUSING	58
4-21028-0	PIN, SLOT SPR (.093 DIA X .75) STR G PLATE	142	690542-2	PAWL, FEED	57
1-21030-1	PIN, DOWEL (.187 DIA X .50) LEVER	141	240624-1	PIN, FEED FINGER	56
1-21030-6	PIN, DOWEL (.187 DIA X 1.25) HOUSING	140	691499-1	SPRING, FEED FINGER	55
21024-5	WASHER, LOCK (NO 10) LUB ASSY	139	690541-1	FINGER, FEED	54
21024-5	WASHER, LOCK (NO 10) STRIP GUIDE ADJ BLOCK	138	455679-1	LEVER, TERMINAL FEED ARM	53
21024-5	WASHER, LOCK (NO 10) ADJ PLATE	137	811242-2	BUMPER, HOLDDOWN	52
21024-5	WASHER, LOCK (NO 10) FEED GUIDE ROD	136	690753-1	SPACER, TONKER	51
21057-2	WASHER, LOCK (NO 4) FRONT STRIP GUIDE	135	7-21002-9	BOLT, CRIMPER	49
21024-4	WASHER, LOCK (NO 8) FEED FINGER	134	690602-5	CAM PRE FEED 1/8 STROKE	48
21024-4	WASHER, LOCK (NO 8) DEPRESSOR	133			47
21024-4	WASHER, LOCK (NO 8) STRIPPER	132	459456-1	APPLICATOR, BASIC (SUB ASSY)	46
21899-4	WASHER, FLAT (5/16 DIA) SCREW ADJ	131	690191-1	PLUG, NYLON	45
21899-2	WASHER, FLAT (NO 10) LUB ASSY	130	455673-1	RAM	44
21068-5	NUT, HEX MACH (6-32) HOLDDOWN	129	690125-1	WASHER, LAMINATED	43
21068-5	NUT, HEX MACH (6-32) FEED ADJ	128	690124-1	WASHER, RAM	42
		127		DISC, SPACER	41
		126	23241-6	BALL, STEEL	40
22353-8	SCR, SHLD. (.187 DIA X .250 LG) DRAG LEVER	125	690170-1	SPRING, COMPRESSION	39
456567-1	SCR, SHLD. (.188 DIA X .125 LG) STRIPPER	124	690142-1	DISC, INSULATION	38
21009-2	SCR, SKT SET (1/4-20 X .25) (LOC-WEL) RAM	123	4-690141-1	DISC, WIRE	37
		122	22480-5	WASHER, SPRING	36
3-21064-2	SCR, RD HD MACH (6-32 X 1.50) FEED ADJ	121	690212-1	POST, RAM	35
		120	690786-3	SUPPORT, TERMINAL	34
2-21002-9	SCR, BUT HD SKT CAP (10-32 X .75) DRAG	119	455675-1	PLATE, BASE	33
2-21002-9	SCR, BUT HD SKT CAP (10-32 X .75) CAP	118	690432-3	SCREW, ADJUSTMENT	32
1-24073-9	SCR, BUT HD SKT CAP (1/4-20 X .75) HOUSING	117			31
2-21002-7	SCR, BUT HD SKT CAP (10-32 X .50) SG ADJ BLOCK	116	455689-1	BLOCK, STRIP GUIDE ADJ	30
2-21002-2	SCR, BUT HD SKT CAP (8-32 X .50) SHEAR	115	455671-1	PLATE, STRIP GUIDE	29
2-21002-1	SCR, BUT HD SKT CAP (8-32 X .38) R STRIP GUIDE	114	1-455888-0	SPACER, FRONT SHEAR DEPRESSOR	28
		113	1-22284-0	SPRING, DRAG	27
2-21003-0	SCR, FLAT HD SKT CAP (6-32 X .50) CAM	112	690546-1	LEVER, DRAG RELEASE	26
3-21000-4	SCR, SKT HD CAP (10-32 X .38) LUBRICATOR ASSY	111	240792-1	DRAG, STOCK	25
23030-1	SCR, SKT HD CAP (6-32 X .25) (LOC-WEL) CP DISC	110	6-690440-0	GUIDE STRIP (REAR)	24
		109	690438-1	GUIDE, STRIP (FRONT)	23
2-21000-7	SCR, SKT HD CAP (8-32 X .50) DEPRESSOR	108			22
2-22603-0	SCR, HEX HD MACH (8-32 X .31) FEED FINGER	107	4-22284-9	SPRING, FEED RETURN	21
1-21000-3	SCR, SKT HD CAP (4-40 X .25) F STRIP GUIDE	106	458950-1	ARM, STRIPPER	20
2-21000-7	SCR, SKT HD CAP (8-32 X .50) STRIPPER	105	458949-1	STRIPPER	19
3-21000-7	SCR, SKT HD CAP (10-32 X .75) FEED ROD GUIDE	104			18
3-21000-6	SCR, SKT HD CAP (10-32 X .62) FEED ADJ BLOCK	103			17
3-21000-4	SCR, SKT HD CAP (10-32 X .38) SG ADJ BLOCK	102	691667-1	GUARD, CHIP (FRONT)	16
3-21000-4	SCR, SKT HD CAP (10-32 X .38) PIVOT BLOCK	101			15
455749-1	GUARD, WINDOW	79			14
1-465184-0	LUBRICATOR ASSY	78			13
852937-2	OIL, LUBRICATING	77	5-22280-0	SPRING, SHEAR	12
		76	690461-1	STOP, SHEAR	11
		75	690459-1	HOLDER, SHEAR (FRONT)	10
458109-1	WASHER, SPECIAL	74	454276-1	SHEAR, FLOAT (FRONT)	9
454877-3	PLATE, STRIP GUIDE COVER	73	3-690471-2	ANVIL	8
690603-1	SPRING, ASSIST	72			7
690517-1	SPACER	71			6
22594-8	NUT, HEX	70	455889-9	DEPRESSOR, SHEAR (REAR)	5
240628-1	PLATE, ADJUSTMENT	69	2-238011-2	SPACER, TUBULAR, INS CRIMPER	4
240626-1	SHAFT, PIVOT	68	6-456134-3	CRIMPER, INSULATION	3
240633-1	BUSHING	67	455888-4	SPACER, CRIMPER	2
455680-1	LEVER, INTERMEDIATE	66	456402-1	CRIMPER, WIRE	1
240629-1	BLOCK, PIVOT	65			
240632-2	SCREW, ADJUSTMENT FEED ROD	64			
240659-3	PIN, CAM ROLLER	63			
240658-1	ROLLER, CAM	62			
454398-2	ROD, FEED	61			
454178-1	GUIDE, FEED ROD	60			

CRIMPING DATA					APPLICATOR WILL APPLY
PAD LTR	CRIMP HEIGHT	WIRE SIZE	STRIP LENGTH		531587
A	.028	24, 26 OR 28			531598
B	NOT USED				
C	NOT USED				
D	NOT USED				
CRIMP	SIZE	TYPE	FEED	APPL INST	
WIRE	055	"F"	400	A1 8040	
INSUL	1090	"F"			
WIRE RANGE	28-24	INSULATION RANGE	1030-060	PRESS NO	565435-5
REMARKS	AMP-O-LECTRIC PRE-FEED				

REMARKS	NO	REV
APPL USED ON MACHINE PART NO	MACH SERIAL NO	DISTRIBUTION
CUSTOMER NAME	APPL SERIAL NO	ORIGINAL
ADDRESS	PURCHASE ORDER	CUSTOMER COPY
CITY	ENG APP	FIELD ENG COPY

THIS INFORMATION IS CONFIDENTIAL AND IS TO BE USED ONLY BY PERSONNEL AUTHORIZED BY AMP INCORPORATED, HARRISBURG, PA.