

▶ QUARTER-TURN LOCKS

MINI QUARTER TURN - WING KNOB

166



- 
- 
- 

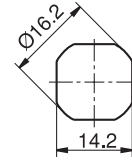
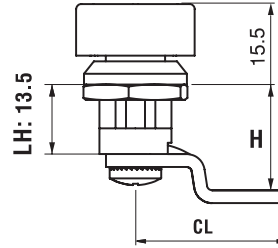

Cut Out

- Wing operates lock and serves as knob
- Sealing washer not supplied

APPLICATIONS

Electric panels, machinery covers

MATERIAL

HOUSING: Zamak DIN-EN 1774-ZnAl4Cu1 or PA6 GFR 30
 KNOB: Zamak DIN-EN 1774-ZnAl4Cu1 or PA6 GFR 30
 CAM: Steel

166 1-1-CC
ZAMAK - CHROME

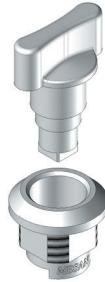

166 1-2-CC
ZAMAK - BLACK COATED



166 2-0-CC
PLASTIC



PRODUCT CODE

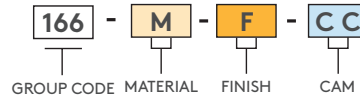

MATERIAL	M	FINISH	F
Zamak	1	Chrome	1
Plastic	2	Black coated	2
		No finish	0

For mixed material and finish lock orders, please use the following coding system:

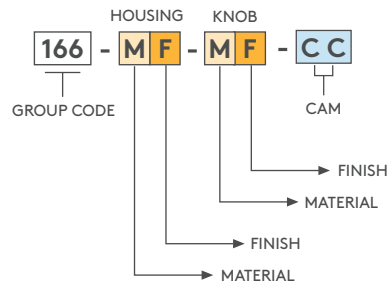

EXAMPLE

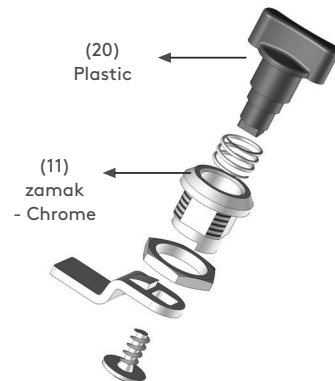

PRODUCT CODE
166 11-20-11

 For cams please check page: 149