

THIS IS A CONTROLLED DOCUMENT.

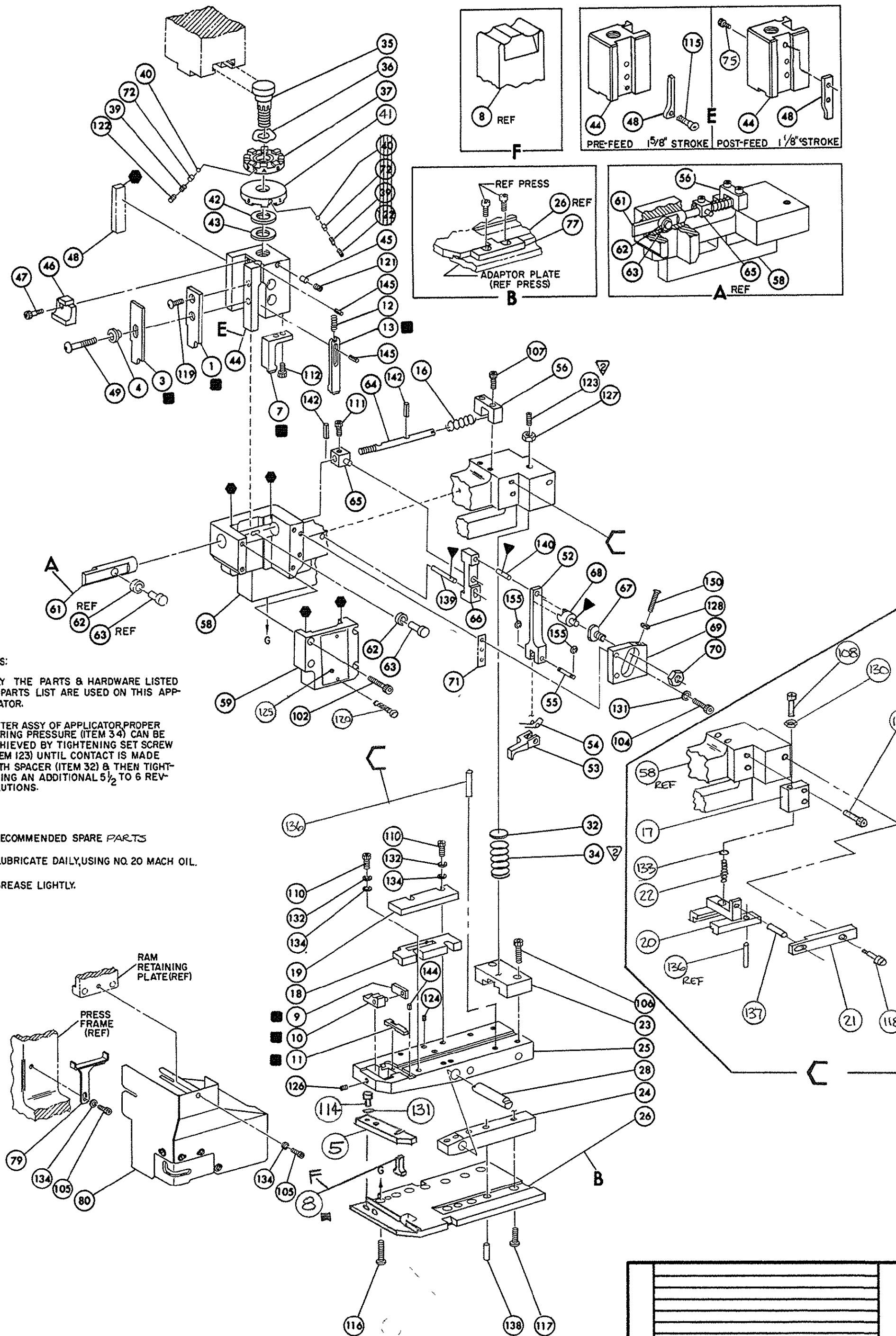

NOTES:
1. ONLY THE PARTS & HARDWARE LISTED ON PARTS LIST ARE USED ON THIS APPLICATOR.
2. AFTER ASSY OF APPLICATOR PROPER SPRING PRESSURE (ITEM 3 & 4) CAN BE ACHIEVED BY TIGHTENING SET SCREW (ITEM 123) UNTIL CONTACT IS MADE WITH SPACER (ITEM 32) & THEN TIGHTENING AN ADDITIONAL 5/2 TO 6 REVOLUTIONS.

KEY:
■ - RECOMMENDED SPARE PARTS
▼ - LUBRICATE DAILY, USING NO. 20 MACH OIL.
● - GREASE LIGHTLY.

REQ.	PART NO.	DESCRIPTION	NO.	REQ.	PART NO.	DESCRIPTION	NO.
	162		1	690517-1	SPACER	71	
	161		1	22594-8	NUT, HEX	70	
	160		1	240628-1	PLATE, ADJUSTMENT	69	
	159		1	240626-1	SHAFT, PIVOT	68	
	158		1	240633-1	BUSHING	67	
	157		1	240630-1	LEVER, INTERMEDIATE	66	
	156		1	240629-1	BLOCK, PIVOT	65	
2	21045-3	RING RET "C" (3/16 DIA) FEED PIN	1	240632-2	SCREW, ADJUSTMENT	64	
	155		1	240659-3	PIN, CAM ROLLER	63	
	154		1	240658-1	ROLLER, CAM	62	
	153		1	240631-1	ROD, FEED	61	
	152		1			60	
	151		1			59	
1	3-21064-1	SCREW RD. HD. MACH. (6-32 X 1.25) FEED ADJ.	1	455164-1	CAP, HOUSING	58	
	149		1	458984-1	HOUSING	57	
	148		1			56	
	147		1	458961-1	GUIDE, FEED ROD	55	
	146		1	240624-1	PIN, FEED FINGER	54	
2	4-21028-9	PIN SLOTTED SPRING (1/8 DIA X .38) RAM	1	691499-1	SPRING, FEED FINGER	53	
1	3-21028-2	PIN, SLOTTED SPRING (3/32 DIA X .25) REAR SHEAR PLATE	1	690584-5	FINGER, FEED	52	
	145		1	240634-1	LEVER, TERMINAL	51	
2	5-21028-1	PIN, SLOTTED SPRING (1/8 DIA X .50) SCREW ADJ. ROD	1			50	
	144		1			49	
	143		1			48	
1	1-21030-2	PIN, DOWEL (3/16 DIA X .62) LEVER	1	3-21002-5	BOLT, CRIMPER	47	
1	1-21030-6	PIN, DOWEL (3/16 DIA X 1.25) HOUSING	1	690696-1	CAM FEED 1/8 STROKE	46	
1	21029-5	PIN, SLOTTED (3/16 DIA X .75) BASE PLATE	1	22353-8	SCREW, SHOULDER	45	
1	21029-3	PIN, SLOTTED SPRING (.187 X .62 LG) DRAG	1			44	
2	1-21030-6	PIN, DOWEL (.187 X 1.25 DIA) DRAG	1	690191-1	RAM	43	
	142		1	691533-1	RAM	42	
	141		1	690125-1	WASHER, LAMINATED	41	
1	21899-3	WASHER, FLAT 1/4 GUARD	1	690124-4	WASHER, RAM	40	
1	21899-1	WASHER, FLAT (#6) DRAG STUD	1	690223-1	DISC, SPACER	39	
4	21024-4	WASHER, LOCK (#8) STRIP GUIDE	1	23241-6	BALL, STEEL	38	
4	21024-5	WASHER, LOCK (#10) FEED ADJ. PLATE & RET PLATE	1	690170-1	SPRING, DISC.	37	
1	21018-7	NUT, HEX (#10) DRAG	1	22480-5	WASHER, SPRING	36	
1	21022-3	NUT, HEX (SELF LOCKING) (#10-32) DRAG STUD	1			35	
1	21018-5	NUT, HEX MACH (6-32) FEED ADJ.	1			34	
1	1-22202-7	NUT HEX MACH (5/16-24) SPRING HOUSING	1	690212-1	POST, RAM	33	
	127		1	3-23846-5	SPRING, HINGE BAR	32	
1	21061-9	SCREW SKT. SET (8-32 X .25) ANVIL INSERT	1	690573-1	SPACER, SPRING	31	
1	461264-1	PLATE, ID	1	454589-1	MOUNT, DRAG	30	
2	4-21006-0	SCREW SKT. SET (8-32 X .25) HINGE PIN	1	3-22354-8	STUD, DRAG	29	
1	8-21007-5	SCREW SKT. SET (5/16-24 X .75) SPRING HOUSING	1	21030-7	MOUNT, PIN, DRAG	28	
1	2-23030-1	SCREW, SKT. HD. CAP. (NYLOK) (6-32 X 25) C. P. DISC.	1	117	463873-1	PLATE, BASE	27
1	21009-2	SCREW SKT. SET (1/4-20 X .25) C. P. RAM	1	116	691535-2	BAR, HINGE	26
2	21017-2	SCR, DRIVE (#2 X .19) ID PLATE	1	115	690571-1	BLOCK, STABILIZER	25
1	2-21002-3	SCREW BTN HD. SKT. CAP (8-32 X .62) CRIMPER	1	114	814222-2	BLOCK, PRESSURE	24
1	1-22853-9	SCR SHLD. SLT. HD. (250 X .250) DRAG	1	113	7-22282-5	SPRING, DRAG	23
3	2-22733-8	SCREW BTN HD. SKT. CAP (1/4-20 X .62) BLOCK, STABILIZER	1	112	458968-1	LEVER, DRAG	22
4	2-22733-8	SCREW BTN HD. SKT. CAP (1/4-20 X .62) HOUSING	1	111	458960-2	DRAG, STOCK	21
1	3-21000-4	SCREW FL HD. SKT. CAP (6-32 X .38) CAM	1	110	691530-1	GUIDE, STRIP, REAR	20
2	7-21000-6	SCREW SKT. CAP (10-32 X 31) ANVIL MTG. PL.	1	109	691529-1	GUIDE, STRIP, FRONT	19
2	2-21000-8	SCREW SKT. HD CAP (8-32 X .62) DRAG MOUNT	1	108	458978-1	BLOCK, SPRING	18
2	23030-4	SCREW SKT. HD CAP (6-32 X .50) NYLOK, SL BLADE	1	107	4-22284-9	SPRING, FEED RETURN	17
1	3-21000-4	SCREW SKT. HD CAP (10-32 X .38) PIVOT BLOCK	1	106			16
4	2-22603-3	SCREW HEX HD CAP (8-32 X .62) FR STRIP GUIDE	1	105			15
2	2-21000-8	SCREW SKT. HD CAP (8-32 X .62) REAR STRIP GUIDE	1	104	692134-5	POSITIONER, TERMINAL	14
1	3-21000-9	SCREW SKT. HD CAP (10-32 X 1.00) DRAG	1	103	5-22280-5	SPRING, TERM, POSITIONER	13
1	3-21000-0	SCREW SKT. HD CAP (8-32 X .37) FEED ROD GUIDE	1	102	691525-1	PLATE, REAR SHEAR	12
2	2-21000-9	SCREW SKT. HD CAP (8-32 X .75) PRESS BLOCK	1	101	691524-1	INSERT, ANVIL	11
1	21001-1	SCREW SKT. HD CAP (1/4-20 X .38) GUARD	1	80	690569-4	PLATE, FRONT SHEAR	10
2	3-21000-6	SCREW SKT. HD CAP (10-32 X .62) FEED PLATE	1	79	691523-1	ANVIL	9
2	221000-9	SCR SKT. HD. CAP (8-32 X .75) DRAG	1	78	691522-1	BLADE, SLUG	8
4	3-21000-8	SCREW SKT. HD CAP (10-32 X .88) HSG. CAP	1	77	455608-1	SPACER, SLUG BLADE	7
1	3-21000-9	SCREW SKT. HD CAP (10-32 X 1.00) CAM	1	76	463874-1	PLATE, ANVIL MOUNTING	6
1	457244-2	GUARD ASSEMBLY	1	75		SPACER TUBULAR, INSUL CRIMPER	5
		BRACKET, GUARD	1	74		CRIMPER, INSULATION	4
		AIR FEED ASSEMBLY	1	73			3
1	694427-1	PLATE, APPLICATOR, MOUNTING	1	72	691531-1	CRIMPER, WIRE	2
			1				1
1	1-21002-7	SCR, BAC, 6-32 X .38	1				
1	690603-1	SPRING, ASSIST	1				

TERM APPL SPEC 114-2078

CRIMPING DATA				THIS APPLICATOR WILL APPLY	
PAD LETTER	CRIMP HEIGHT	WIRE SIZE	WIRE STRIP LENGTH		
A	.072	12		61177-1	
B	.062	14		61177-2	
C	.056	16			
D	.052	18			
CRIMP	SIZE	TYPE	FEED	PRESS REF.	
WIRE	.160	T.L.	.620	56S435-5	
INSULATION	++	++			
INSULATION RANGE		WIRE RANGE	APPLICATOR INSTRUCTION	M	
		18-12			
REMARKS AMP-O-LECTRIC PRE-FEED					
— INACTIVE — FOR REPLACEMENT ONLY					
SET UP GAGE	LAYOUT NO.	AMP INCORPORATED HARRISBURG, PENNA.			
DRAWN 5-9-73	APPROVED	Loc A C No. 1-686961-1 M			
CHECKED S-10-73	REL.				
SCALE NONE	NAME	APPLICATOR, MINIATURE QUICK CHANGE HINGE BAR, E.F. (TAB LOK (RIGHT HAND))			

REV	DATE	DESCRIPTION	BY	CHK
A	5-06			
L	9-04			
K	7-92			
J	5-91			
H	11-76			
G	11-76			
F	2-77			
E	7-74			
D	8-73			
C	10-74			
B	8-73			
A	8-73			

THIS INFORMATION IS CONFIDENTIAL AND IS LOANED TO YOU ON THE CONDITION THAT NO PARTS OR DIMENSIONS WILL BE REPRODUCED OR COPIED IN ANY MANNER WITHOUT THE WRITTEN AUTHORIZATION OF AMP INCORPORATED. ALL RIGHTS RESERVED. COPYRIGHT 2000.