

10 9 8 7 6 5 4 3 2 1

Part Number	CKT SIZE	VOID POSITION	DIMENSION						PACKING TYPE
			A	B	M	H	T	F	
87951-0001	8	-----	19.90	17.50	10.00	10.30	3.50	23.80	TRAY
87951-0002	8	-----	19.90	17.50	10.00	15.30	3.50	28.80	TRAY

NOTE:

1. WAFER TO BE FLAT WITHIN 0.003in/in or mm/mm.
2. MATERIAL: HSG: PA66, GLASS FILLED, UL-94V-2, COLOR: NATURAL. PIN: COPPER ALLOY
3. PLATING FINISH: 100MNCHES MIN TIN OVER 50MNCHES MIN NICKEL UNDERPLATE OVERALL.
4. PIN PUSHOUT FORCE: 1KG MIN. IN EITHER DIRECTION.
5. HEADER MAY BE BROKEN TO DESIRE CKT SIZE, SLIGHTLY FLASHES SHOULD BE ACCEPTED.
6. PARTS TO BE PACKED IN TRAY.

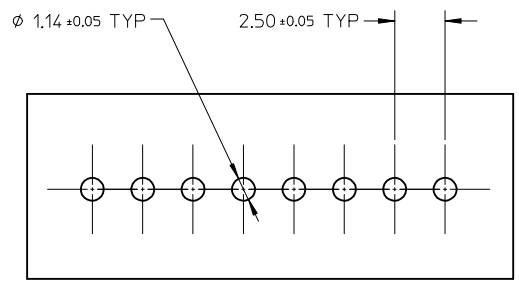
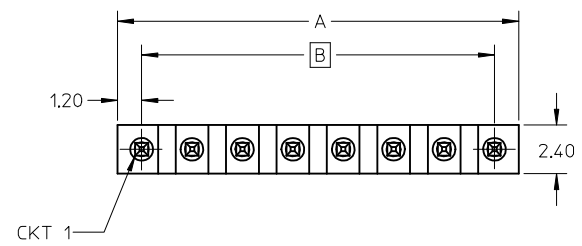

RECOMMENDED P.C.B. HOLE LAYOUT

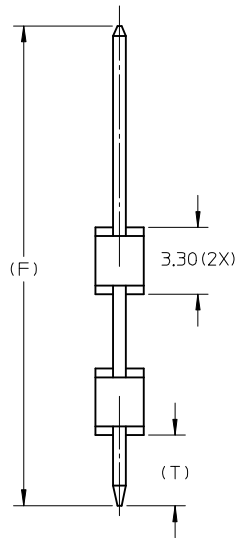
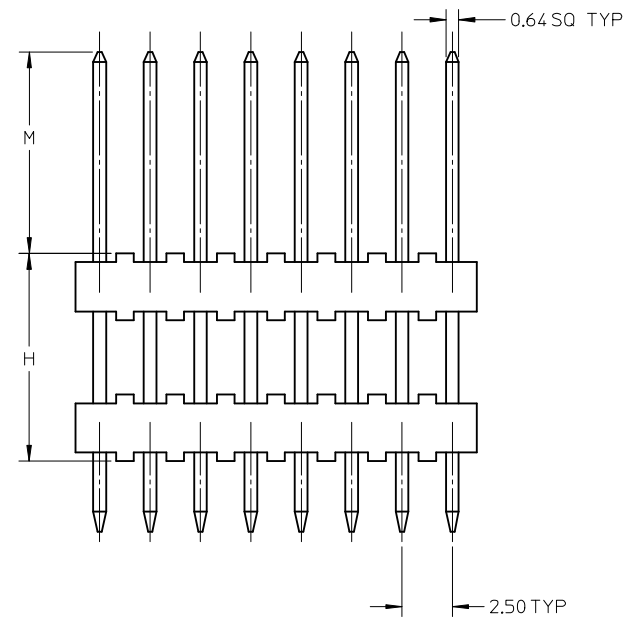

EC NO: S2005-1060 DRWN:CHO 2005/07/22 CHKD:RAOVLN 2005/07/22 APPR:PTLIIM 2005/07/25 A1	QUALITY SYMBOLS ▽=0 Ⓢ=0	GENERAL TOLERANCES (UNLESS SPECIFIED)		DIMENSION STYLE	SCALE	DESIGN UNITS	THIRD ANGLE PROJECTION	
				MM ONLY	NTS	METRIC		
		mm	INCH	DRAWN BY	DATE	TITLE		
		4 PLACES	± ---	± ---	YLQ1A0	2004/10/20	SALES DRAWING SINGLE ROW DUAL WAFER 2.50MM PITCH, T/H	
3 PLACES	± ---	± ---	CHECKED BY	DATE	MOLEX INCORPORATED			
2 PLACES	± 0.25	± ---	KMGOH	2004/10/26	DOCUMENT NO.			
1 PLACE	± ---	± ---	APPROVED BY	DATE	SHEET NO.			
ANGULAR ± 3 °		DRAFT WHERE APPLICABLE MUST REMAIN WITHIN DIMENSIONS		SCLOW	2004/10/26	SD-87951-001		
				MATERIAL NO.	SEE TABLE			
				SIZE	THIS DRAWING CONTAINS INFORMATION THAT IS PROPRIETARY TO MOLEX INCORPORATED AND SHOULD NOT BE USED WITHOUT WRITTEN PERMISSION			

9 8 7 6 5 4 3 2 1