

PC board drilling dimensions (after plating)  
(thickness <math>\leq 3.20 \pm 0.30\text{mm}</math>)

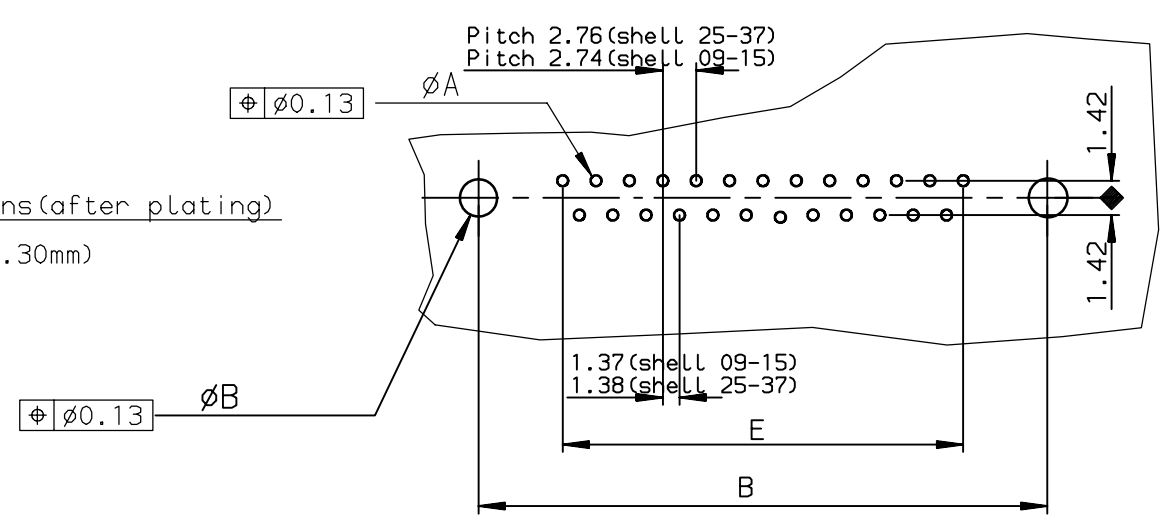

TIN LEAD PART NUMBER

SHELL	A±0.38	B±0.12	C±0.10	D±0.25	E±0.07	PART NUMBER
09	30.81	24.99	16.96	16.21	10.96	D09S93C6PA00
15	39.14	33.32	25.18	24.54	19.18	D15S93C6PA00
25	53.03	47.04	39.12	38.25	33.12	D25S93C6PA00
						0.76μ gold

LEAD FREE PART NUMBER

SHELL	A±0.38	B±0.12	C±0.10	D±0.25	E±0.07	PART NUMBER
09	30.81	24.99	16.96	16.21	10.96	D09S93C6PA00LF
15	39.14	33.32	25.18	24.54	19.18	D15S93C6PA00LF
25	53.03	47.04	39.12	38.25	33.12	D25S93C6PA00LF
						0.76μ gold

GENERAL CHARACTERISTICS AND ROHS INFORMATIONS:  
SEE DRAWING C01-8646-0001

European Views

www.fciconnect.com		surface ISO 1302 ✓	tolerance std ISO 406 ISO 1101	projection mm
TOLERANCES UNLESS OTHERWISE SPECIFIED				size A3
Dr	PESSON	2005/06/22	ANGULAR	Scale 2
Eng	PESSON	2005/06/22	LINEAR	ECN LS06-0140
Chr	LEGARE	2005/06/22	0.xx' ±2'	Spec ref -
Appr	LEGARE	2005/06/22	Product family	D-SUB
FCi		title FEMALE CONNECTOR DELTA D straight press-fit		dwg no C01-8646-0870
-		-		Rev. C
-		-		CUSTOMER sheet 1 of 1

rev	ecn no	dr	date
A	-	MPE	2005/06/22
B	LS06-0097	LGO	2006/07/28
C	LS06-0140	LGO	2006/09/16
-	-	-	-
-	-	-	-
-	-	-	-
-	-	-	-