

# 0805 Multilayer Chip Inductors, High Frequency Applications

## Special Features

- Monolithic construction provides high reliability
- High Q characteristic
- Ceramic material construction provides very stable electrical characteristics
- Operating temperature -25 to +105°C
- Current to cause 20°C temperature rise
- Tape & reel packaged  
2000/reel (1.25 thickness)  
4000/reel (0.85 thickness)

## Typical Applications

- Small cellular phones
- PDAs
- Pagers
- Handheld organizers
- High-frequency wireless communication devices
- Notebook computers
- Printers
- Network cards
- Industrial electronics
- Entertainment electronic devices

| PM0805H Series |                   |        |             |           |       |      |            |             |
|----------------|-------------------|--------|-------------|-----------|-------|------|------------|-------------|
| Part Number    | L (nH)<br>± 0.3nH | Q Typ. | Test        | Q Typ.    | SRF   | DCR  | Thickness  |             |
|                |                   |        | Freq. (MHz) | @ 800 MHz | (MHz) | (Ω)  | I, DC (mA) | Dim. A (mm) |
| PM0805H-1N5    | 1.5               | 10     | 100         | 50        | 6000  | 0.10 | 300        | 0.85        |
| PM0805H-1N8    | 1.8               | 10     | 100         | 52        | 6000  | 0.10 | 300        | 0.85        |
| PM0805H-2N2    | 2.2               | 11     | 100         | 53        | 6000  | 0.10 | 300        | 0.85        |
| PM0805H-2N7    | 2.7               | 12     | 100         | 56        | 6000  | 0.10 | 300        | 0.85        |
| PM0805H-3N3    | 3.3               | 13     | 100         | 56        | 6000  | 0.13 | 300        | 0.85        |
| PM0805H-3N9    | 3.9               | 13     | 100         | 58        | 5400  | 0.15 | 300        | 0.85        |
| PM0805H-4N7    | 4.7               | 14     | 100         | 58        | 4500  | 0.20 | 300        | 0.85        |
| PM0805H-5N6    | 5.6               | 14     | 100         | 60        | 4000  | 0.23 | 300        | 0.85        |
| ± 5%           |                   |        |             |           |       |      |            |             |
| PM0805H-6N8J   | 6.8               | 15     | 100         | 60        | 3650  | 0.25 | 300        | 0.85        |
| PM0805H-8N2J   | 8.2               | 15     | 100         | 64        | 3000  | 0.28 | 300        | 0.85        |
| PM0805H-10NJ   | 10                | 15     | 100         | 60        | 2500  | 0.30 | 300        | 0.85        |
| PM0805H-12NJ   | 12                | 16     | 100         | 60        | 2450  | 0.35 | 300        | 0.85        |
| PM0805H-15NJ   | 15                | 16     | 100         | 63        | 2200  | 0.40 | 300        | 0.85        |
| PM0805H-18NJ   | 18                | 17     | 100         | 63        | 1750  | 0.45 | 300        | 0.85        |
| PM0805H-22NJ   | 22                | 18     | 100         | 60        | 1700  | 0.50 | 300        | 0.85        |
| PM0805H-27NJ   | 27                | 17     | 100         | 58        | 1550  | 0.55 | 300        | 0.85        |
| PM0805H-33NJ   | 33                | 18     | 100         | 55        | 1350  | 0.60 | 300        | 0.85        |
| PM0805H-39NJ   | 39                | 18     | 100         | 47        | 1300  | 0.65 | 300        | 0.85        |
| PM0805H-47NJ   | 47                | 18     | 100         | 43        | 1200  | 0.70 | 300        | 0.85        |
| PM0805H-56NJ   | 56                | 19     | 100         | 39        | 1150  | 0.75 | 300        | 0.85        |
| PM0805H-68NJ   | 68                | 19     | 100         | 30        | 1000  | 0.80 | 300        | 0.85        |
| PM0805H-82NJ   | 82                | 19     | 100         | 10        | 850   | 0.90 | 300        | 0.85        |
| PM0805H-100NJ  | 100               | 23     | 100         | -         | 700   | 0.90 | 300        | 1.25        |
| PM0805H-120NJ  | 120               | 16     | 50          | -         | 650   | 0.95 | 300        | 1.25        |
| PM0805H-150NJ  | 150               | 16     | 50          | -         | 550   | 1.00 | 300        | 1.25        |
| PM0805H-180NJ  | 180               | 16     | 50          | -         | 500   | 1.10 | 300        | 1.25        |
| PM0805H-220NJ  | 220               | 16     | 50          | -         | 430   | 1.20 | 300        | 1.25        |
| PM0805H-270NJ  | 270               | 18     | 50          | -         | 650   | 0.95 | 300        | 1.25        |
| PM0805H-330NJ  | 330               | 18     | 50          | -         | 550   | 1.00 | 300        | 1.25        |
| PM0805H-390NJ  | 390               | 18     | 50          | -         | 500   | 1.10 | 300        | 1.25        |
| PM0805H-470NJ  | 470               | 16     | 50          | -         | 430   | 1.20 | 300        | 1.25        |

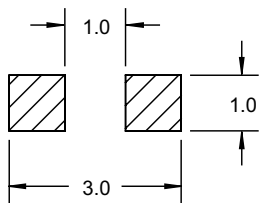
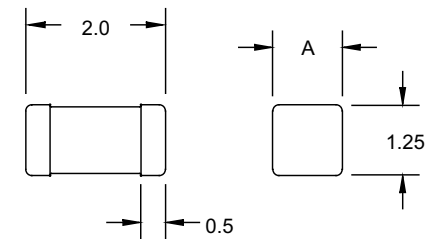

Pad Layout

Tol:  $\pm 0.2$   
Dim: mm

**J.W. Miller**  
M A G N E T I C S

306 E. Alondra Blvd., Gardena, CA 90247-1059 • (310) 515-1720 • FAX (310) 515-1962

www.jwmiller.com