

Development Board Products

1593HAM Series

Enclosures

Hammond's 1593HAM series of plastic enclosure are specifically designed to house many of the most popular development boards and miniature computers on the market.

Hammond Eggs

are open-air platforms on which Arduinos or Raspberry Pi's can be mounted. The adaptable underside can be used to mount PC boards, panels, and is even compatible with popular interlocking brick systems.

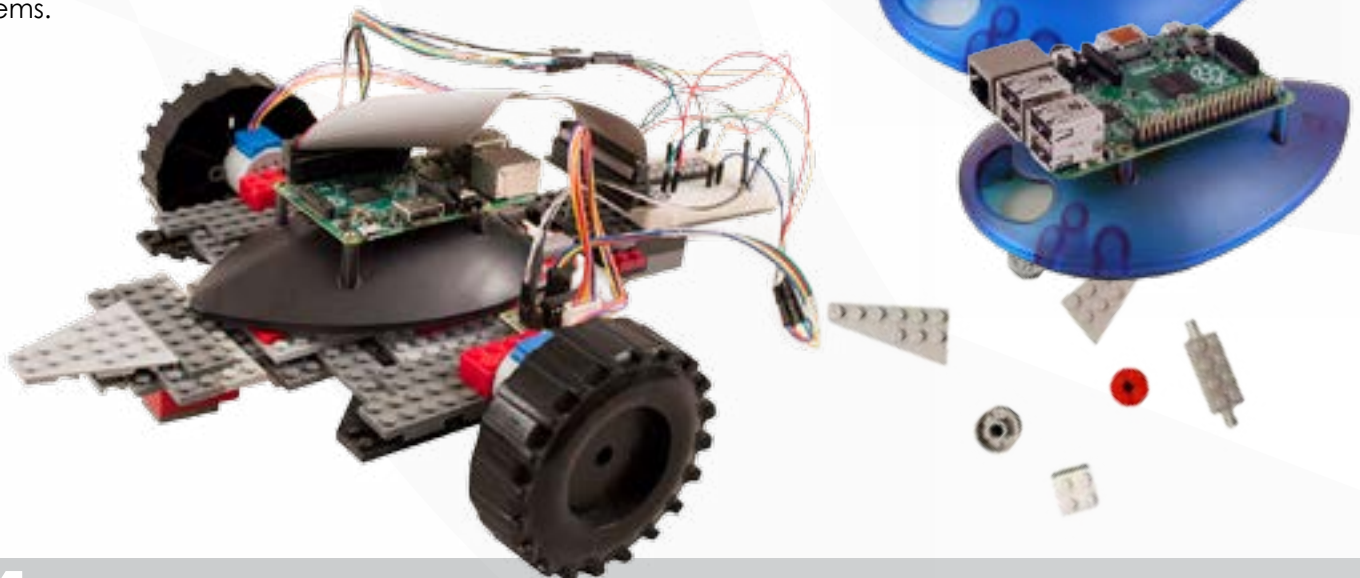

Products Designed For

Arduino

Development Board Enclosures

*Arduinos are not included with enclosures or Eggs.

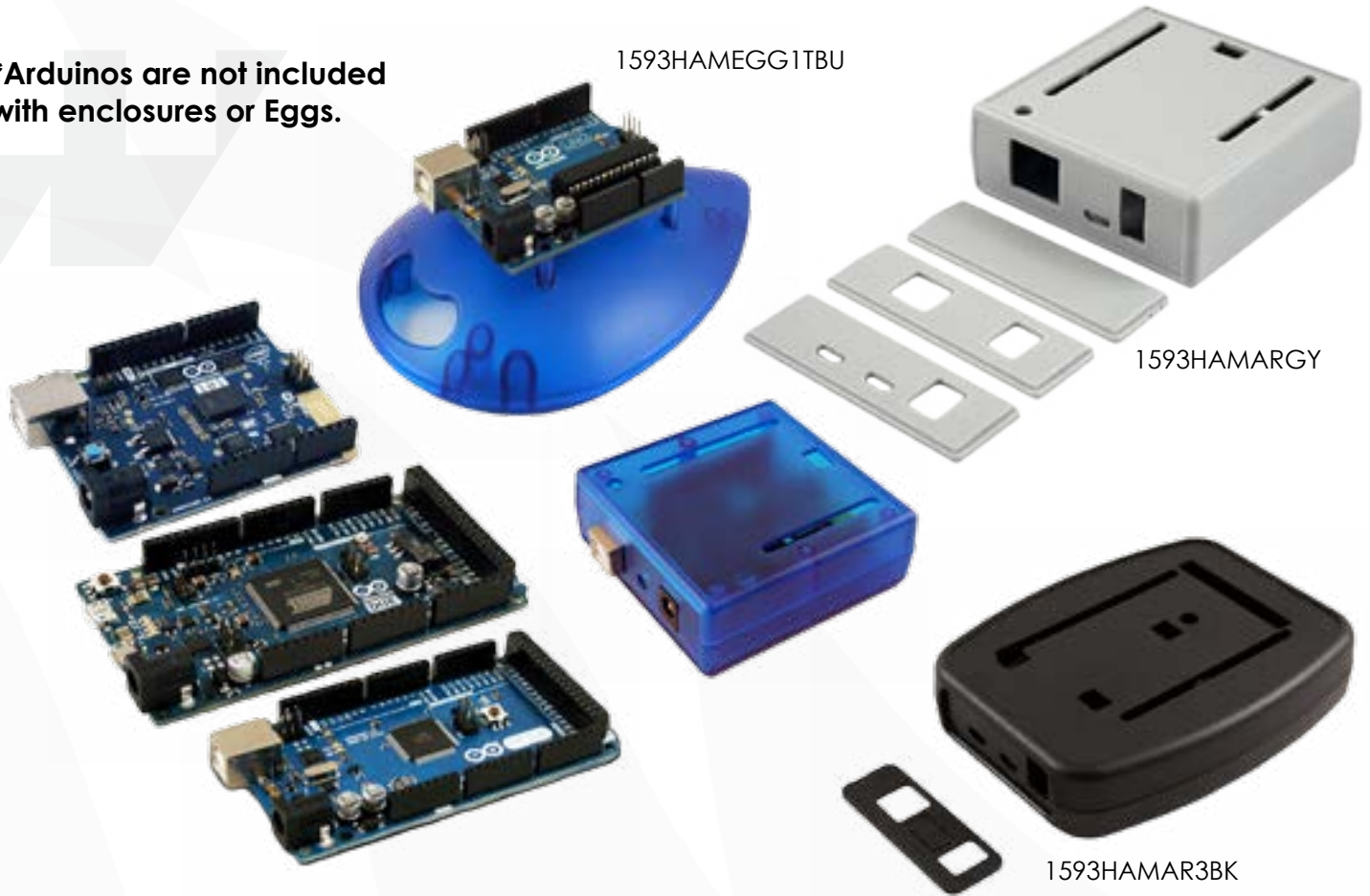

Part Number	Color	Units	Length	Width	Height	Compatible Arduino Models
1593HAMARBK	Black	in. mm	2.95 75	2.81 74	1.06 27	Leonardo, M0 Pro, Uno, Yun
1593HAMARGY	Gray					
1593HAMARTBU	Trans Blue					
1593HAMAR2TBU	Trans Blue	in. mm	4.72 120	3.74 95	1.06 27	Leonardo, M0 Pro, Uno, Yun, 101
1593HAMAR3BK	Black					
1593HAMAR3GY	Gray					
1593HAMAR3TBU	Trans Blue	in. mm	5.71 145.1	3.94 100.1	1.3 33	Uno, Due, Leonardo, Ethernet, Mega ADK, Mega 2560, Yun, 101
1593HAMEGG1TBK	Trans Black					
1593HAMEGG1TBU	Trans Blue					
1593HAMEGG1TPU	Trans Purple					



www.hammondmfg.com

USA

(716) 630-7030

Canada

(519) 822-2960

Quebec

(450) 975-1884

Europe (UK)

01256 812812

Australia

+61-8-8240-2244

Products Designed For

Raspberry Pi

Development Board Enclosures



1593HAMEGG2TBU



***Raspberry Pi's are not included with enclosures or Eggs.**



Part Number	Color	Units	Length	Width	Height	Compatible Raspberry Pi Models
1593HAPI3BK	Black	in mm	3.88 98.54	2.74 69.49	1.16 29.6	Raspberry Pi 3 model B
1593HAPI3CLR	Clear					
1593HAPI3GY	Gray					
1593HAPI3TBU	Trans Blue					
1593HAPI2BK	Black	in mm	3.88 98.54	2.74 69.49	1.16 29.6	Raspberry Pi Model B+ Raspberry Pi 2 Model B
1593HAPI2CLR	Clear					
1593HAPI2GY	Gray					
1593HAPI2TBU	Trans Blue					
1593HAPIBK	Black	in mm	4.1 104.2	2.58 65.5	1.18 30	Raspberry Pi Model B
1593HAPICLR	Clear					
1593HAPIGY	Gray					
1593HAPITBU	Trans Blue					
1593HAMEGG1TBK	Trans Black	in mm	5.71 145.1	3.94 100.1	1.3 33	Raspberry Pi Model A+ Raspberry Pi Model B Raspberry Pi Model B+ Raspberry Pi 2 Model B Raspberry Pi 3 Model B
1593HAMEGG1TBU	Trans Blue					
1593HAMEGG1TPU	Trans Purple					



www.hammondmfg.com

USA

(716) 630-7030

Canada

(519) 822-2960

Quebec

(450) 975-1884

Europe (UK)

01256 812812

Australia

+61-8-8240-2244

Products Designed For Beaglebone

Development Board Enclosures



Part Number	Color	Units	Length	Width	Height	Compatible Beaglebone Models
1593HAMDOGBK	Black	in mm	3.75 95	3.04 77	1.18 30	Beaglebone (white)
1593HAMDOGGY	Gray					
1593HAMDOGTBU	Trans Blue					
1593HAMBONEBK	Black	in mm	3.75 95	3.04 77	1.18 30	Beaglebone Black
1593HAMBONEGY	Gray					
1593HAMBONETBU	Trans Blue					
1593HAMBOGRBK	Black	in mm	3.75 95	3.04 77	1.18 30	Beaglebone Green
1593HAMBOGRGY	Gray					
1593HAMBOGRTBU	Trans Blue					



***Beaglebones are not included with enclosures.**



Products Designed For Intel & Freescale

Development Board Enclosures



Part Number	Color	Units	Length	Width	Height	Compatible Models
1593HAMFREE1BK	Black	mm in	3.6 92	2.6 66	1.1 28	Freescale Freedom FRDM-KL02Z & FRDM- KL05Z
1593HAMFREE1GY	Gray					
1593HAMFREE1TBU	Trans Blue					
1593HAMFREE2BK	Black	mm in	3.6 92	2.6 66	1.1 28	Freescale Freedom FRDM-KL25Z
1593HAMFREE2GY	Gray					
1593HAMFREE2TBU	Trans Blue					
1593HAMGAL2TBU	Trans Blue	in mm	5.71 145	3.09 78.5	1.79 45.5	Intel Galileo Gen 2



***Boards are not included
with enclosures.**

