

PRODUCT NUMBER	PITCH
Klxx50x300J0G	5.08 mm

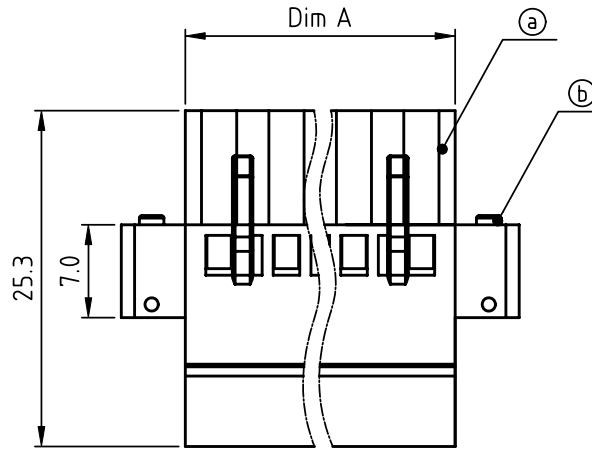
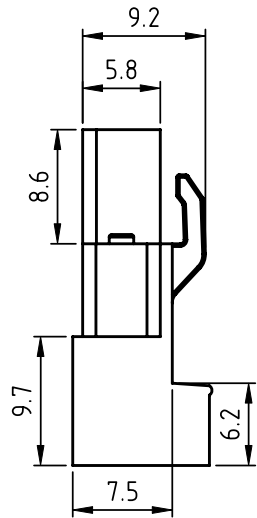
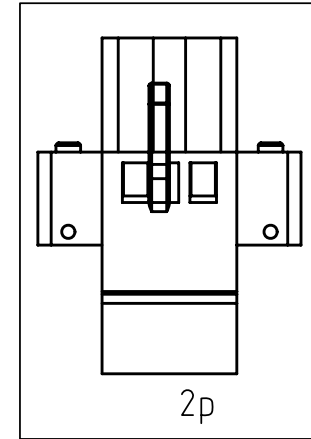
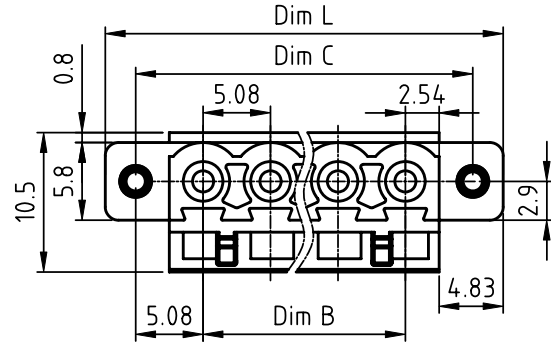

Material:

- Item (a) Terminal housing: Thermoplastic (UL94 V-0)
- Item (b) With flange screw: Steel Zinc plated, M2.5" +/-"

Electrical cULus

- Voltage rating: 300V
- Current rating: 10A
- Wire range: 0.5-1.0mm²/1.5-2.5mm²
- Withstanding Voltage: 1.6KV
- Corresponding female crimp contacts: A0 5.08 series

N = Number of poles
 Dim L=(N-1)x5.08+14.74
 Dim A=Nx5.08
 Dim B=(N-1)x5.08
 Dim C=(N-1)x5.08+10.16

PART NO.: **KI xx 50 x 3 00J0 G**

		Color	RoHS compliant
Solid block	0	Black (RAL9005)	(lead<4%)
No. of poles	2	Red (RAL3001/D)	In copper Alloy
02 2 poles	3	Orange(RAL2011/P)	
03 3 poles	4	Yellow(RAL1018/A)	
...	...	5 Green(RAL6018/T)	
24 24 poles	6	Blue (RAL5015/A)	
		8 Grey(RAL7035/D)	
		9 White(RAL1102)	
		C Green(RAL6018/U)	

Poles	Dim L	Dim A	Dim B	Dim C
2-6p	±0.20	±0.20	±0.20	±0.20
7-12p	±0.25	±0.25	±0.25	±0.25
13-16p	±0.30	±0.30	±0.30	±0.30
17-24p	±0.40	±0.40	±0.35	±0.40

mat'l. code		surface ASME Y14.5	tolerance ASME Y14.5	projection	product family TERMINAL BLOCK
ltr	ecn no	dr	date	 MM	title TERMINAL BLOCK PLUGGABLE PLUG, WITH FLANGE, CRIMP CONNECTION WITH HIGH PROFILE
tolerances unless otherwise specified					
angles		X.±0.5			dwg no Klxx50x300J0G sheet 1 of 1 size A4
X*±1"		X.XX±0.1			
dr	EVIN ZHONG	050414			
enr	EVIN ZHONG	050414		type CUSTOMER Drawing	
chr	HANKE FENG	050414			
appd	SHI JUN	050414			
sheet index	revision sheet	A	1		