

NOTES:

- ① MAT'L: COPPER (STOCK TKN. $\frac{.031}{.79}$) $\pm .001$
- PLATING: ELECTRO-TIN (.0003 MIN.)

STUD SIZES: ($\pm .005$)

- 02 = .094
- 04 = .119
- 06 = .146
- 08 = .173
- 10 = .198
- 14 = .265
- 56 = .328
- 38 = .390

"UL" LISTING *E32244
 "CSA" LISTING #18689

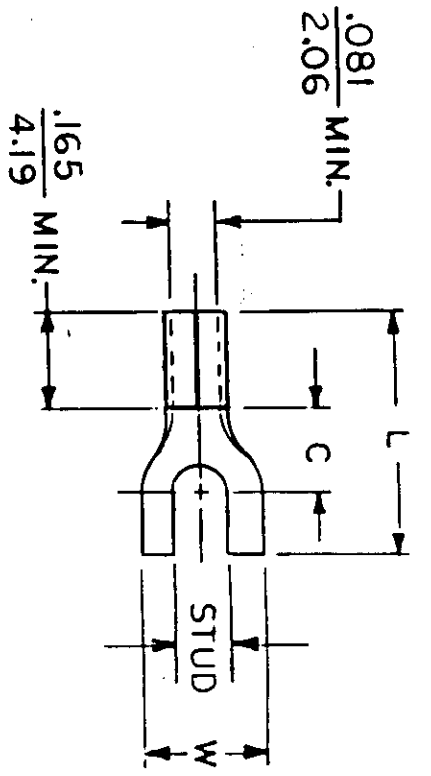

ALL DIMENSIONS = $\frac{\text{INCHES}}{\text{M M}}$

WIRE SIZE: 16 - 14 AWG
 1.0 - 2.5 MM²

PART NUMBER	"W"	"C" MIN.	"L" MAX.	AVAILABLE STUD SIZES	TITLE:	
					SPADE TONGUE TERMINAL	KRIMPTITE 100-SERIES
BB-107-	$\frac{.245}{6.22}$	$\frac{.209}{5.31}$	$\frac{.565}{14.35}$	04, 06	DRWN. BY: <i>Y</i>	10-18-84
BB-124-	$\frac{.295}{7.49}$	$\frac{.211}{5.36}$	$\frac{.564}{14.33}$	04, 06, 08	CHKD. BY: <i>GT</i>	11-2-84
BB-127-	$\frac{.362}{9.19}$	$\frac{.269}{6.83}$	$\frac{.687}{17.45}$	06, 08, 10	APPRD. BY:	
DIMENSIONAL TOLERANCES UNLESS OTHERWISE SPECIFIED					SCALE: NTS	DATE
FRAC. DEC. ANG.					SCALE: NTS	DATE
± ± ±					SCALE: NTS	DATE



DWG. NO. A CUSTOMER DWG.

10	9	8	7	6	5	
MATERIAL NUMBER	ALTERNATE NUMBER	STUD SIZE	"S" ±.005/(0.13)	"W" ±.010/(0.25)	"C" MIN (A1)	"L" MAX (A1)
191410050	BB-107-04	4	.119/(3.02)	.245/(6.22)	.209/(5.31)	.565/(14.35)
191410052	BB-107-06	6	.146/(3.71)	.245/(6.22)	.209/(5.31)	.565/(14.35)
191410054	BB-124-04	4	.119/(3.02)	.295/(7.49)	.211/(5.36)	.564/(14.33)
191410056	BB-124-06	6	.146/(3.71)	.295/(7.49)	.211/(5.36)	.564/(14.33)
191410058	BB-124-08	8	.173/(4.39)	.295/(7.49)	.211/(5.36)	.564/(14.33)
191410061	BB-127-06	6	.146/(3.71)	.362/(9.19)	.269/(6.83)	.687/(17.45)
191410063	BB-127-08	8	.173/(4.39)	.388/(9.85)	.269/(6.83)	.687/(17.45)
191410065	BB-127-10	10	.198/(5.03)	.388/(9.85)	.269/(6.83)	.687/(17.45)
191410051	BB-107-04T	4	.119/(3.02)	.245/(6.22)	.209/(5.31)	.565/(14.35)
191410053	BB-107-06T	6	.146/(3.71)	.245/(6.22)	.209/(5.31)	.565/(14.35)
191410055	BB-124-04T	4	.119/(3.02)	.295/(7.49)	.211/(5.36)	.564/(14.33)
191410057	BB-124-06T	6	.146/(3.71)	.295/(7.49)	.211/(5.36)	.564/(14.33)
191410059	BB-124-08T	8	.173/(4.39)	.295/(7.49)	.211/(5.36)	.564/(14.33)
191410062	BB-127-06T	6	.146/(3.71)	.362/(9.19)	.269/(6.83)	.687/(17.45)
191410064	BB-127-08T	8	.173/(4.39)	.388/(9.85)	.269/(6.83)	.687/(17.45)
191410066	BB-127-10T	10	.198/(5.03)	.388/(9.85)	.269/(6.83)	.687/(17.45)

PACKAGING

LOOSE PIECE

TAPE MOUNTED

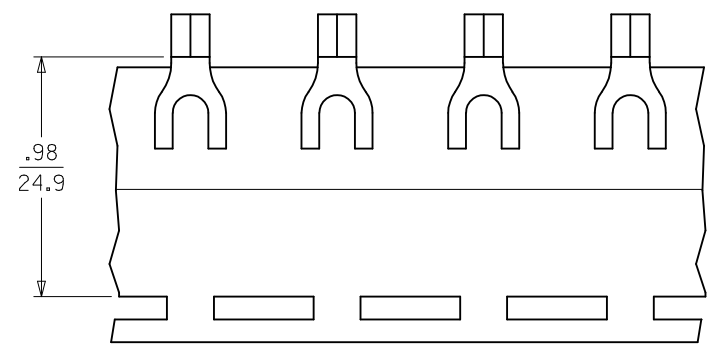

PARTS ON TAPE

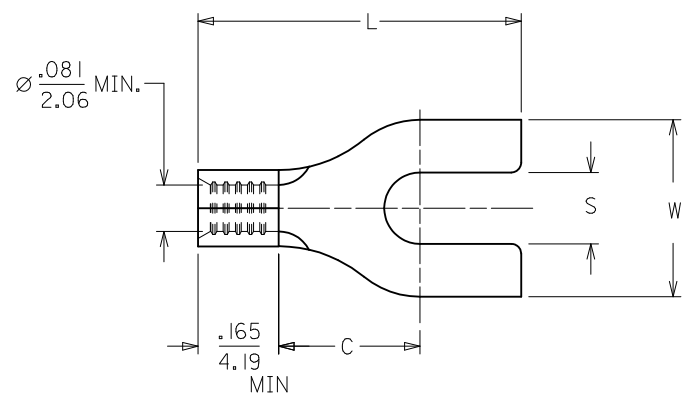

CUSTOMER DRAWING

NOTES:
 1. MATERIAL: COPPER .031/(.79) THICK.
 2. PLATING: ELECTRO-TIN.
 3. PARTS ARE ROHS COMPLIANT. (A1)

ADD MISSING TOLRNC EC NO: WNA2010-0362 DRAWN: THRODAHL 2009/12/21 CHKD: JMACNEIL 2009/12/21 APPR: JMACNEIL 2009/12/21 A1	QUALITY SYMBOLS ▽=0 ▽7=0	GENERAL TOLERANCES (UNLESS SPECIFIED) mm INCH 4 PLACES ± --- ± --- 3 PLACES ± --- ± .005 2 PLACES ± 0.13 ± .01 1 PLACE ± 0.25 ± --- ANGULAR ± ---°	DIMENSION STYLE IN/MM DRAWN BY DATE HEB 1999/11/12 CHECKED BY DATE RWD 1999/11/12 APPROVED BY DATE RWD 1999/11/12	SCALE --- DESIGN UNITS INCH THIRD ANGLE PROJECTION	TITLE SPADE TONGUE TERMINAL 16-14 AWG KRIMPTITE SERIES MOLEX INCORPORATED DOCUMENT NO. SD-19141-001 SHEET NO. 1 OF 1
	DRAFT WHERE APPLICABLE MUST REMAIN WITHIN DIMENSIONS		MATERIAL NO. SEE CHART	MOLEX INCORPORATED	
			THIS DRAWING CONTAINS INFORMATION THAT IS PROPRIETARY TO MOLEX INCORPORATED AND SHOULD NOT BE USED WITHOUT WRITTEN PERMISSION		