

SECTION D-D

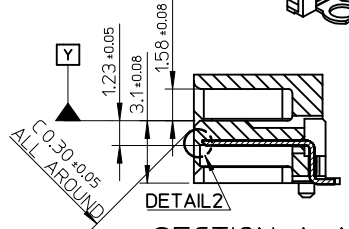

SECTION A-A

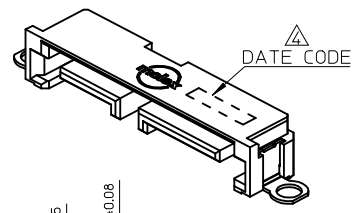
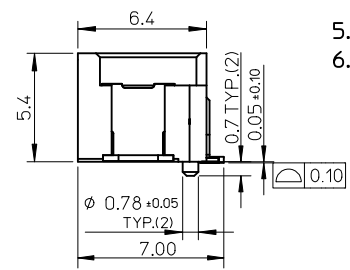
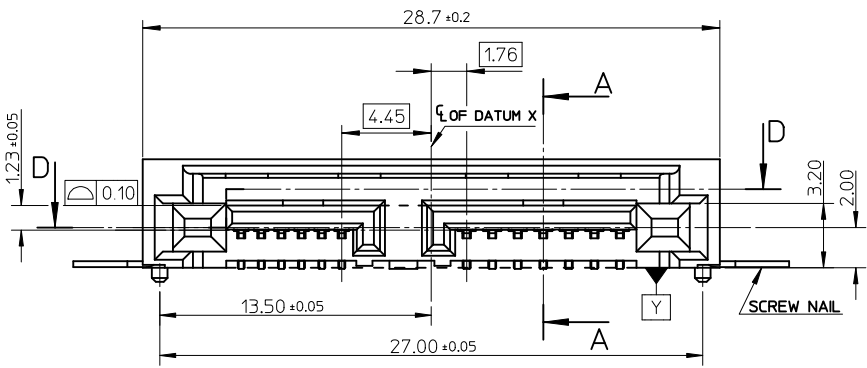

DETAIL2

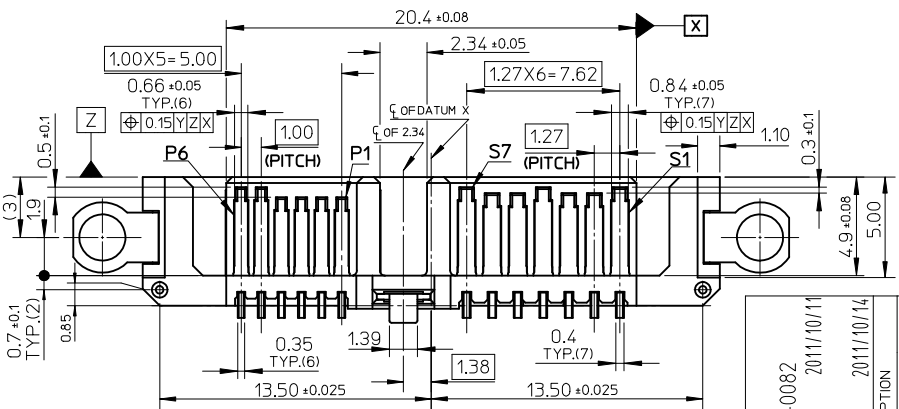

NOTES :

- 1.MATERIAL :
HOUSING : HIGH TEMPERATURE THERMOPLASTIC, 30% G.F., UL94V-0, BLACK
TERMINAL : COPPER ALLOY, THICKNESS=0.25 MM
SCREW NAIL : STAINLESS, THICKNESS=0.30 MM
SOLDERING NAIL : COPPER ALLOY, THICKNESS=0.30 MM
- 2.PLATING :
TERMINAL :
CONTACT AREA : SEE CHART.
SOLDERING AREA : MATTE TIN PLATING 1.0 MICRONS MIN.
UNDERPLATING : NICKEL PLATING 2.5 MICRONS MIN.
SOLDERING NAIL : MATTE TIN PLATING 1.0 MICRONS MIN.
OVER NICKEL PLATING 1.0 MICRONS MIN.
- 3.PRODUCT SPECIFICATION: PS-47300-001.
- DATE CODE FORMAT: YY/MM/DD/XX/S, 'XX' IS USED TO MARK TERMINAL GOLD PLATING SPEC, '05' IS FOR FLSH, '15' IS FOR 15u", '30' IS FOR 30u". 'S' IS A SPECIAL LETTER FOR FACTORY TO TRACK.
- 5.PRODUCT PACKAGE SPEC: PK-47300-001.
- 6.THE PRODUCT COMPLIANT TO RoSH DIRECTIVE 2002/95/EC AND ELV DIRECTIVE 2000/53/EC.

P/N	CONTACT PLATING	NAIL
47300-1000	GOLD FLASH	
47300-1002	GOLD 0.38 MICRONS MIN	STAINLESS STEEL, NO PLATING
47300-1004	GOLD 0.76 MICRONS MIN	
47300-1001	GOLD FLASH	
47300-1003	GOLD 0.38 MICRONS MIN	PHOSPHOR BRONZE, MATTE TIN PLATING
47300-1005	GOLD 0.76 MICRONS MIN	

REVISED EC NO: SH2012-0082 DRAWING: GLL1 CHK'D: APPR: X.J.SONG 2011/10/11 2011/10/14	QUALITY SYMBOLS	GENERAL TOLERANCES (UNLESS SPECIFIED)	DIMENSION STYLE	SCALE	DESIGN UNITS	THIRD ANGLE PROJECTION	
	$F_{\sigma} = 0$ $F_{\tau} = 0$ $F_{\beta} = 0$	mm INCH 4 PLACES ± --- ± --- 3 PLACES ± --- ± --- 2 PLACES ± --- ± --- 1 PLACE ± --- ± ---	MM ONLY	4:1	METRIC		
	DRAFT WHERE APPLICABLE MUST REMAIN WITHIN DIMENSIONS	ANGULAR ± 3 °	DRAWN BY: GLL1 CHECKED BY: APPROVED BY: DATE: 2011/10/11	TITLE	SLIMLINE SATA PLUG FOR OPTIC DISK DIVER SCREW STANDARD TYPE		
			MATERIAL NO. SEE TABLE SIZE: A3 THIS DRAWING CONTAINS INFORMATION THAT IS PROPRIETARY TO MOLEX INCORPORATED AND SHOULD NOT BE USED WITHOUT WRITTEN PERMISSION	MOLEX INCORPORATED DOCUMENT NO. SD-47300-100 SHEET NO. 1 OF 7			

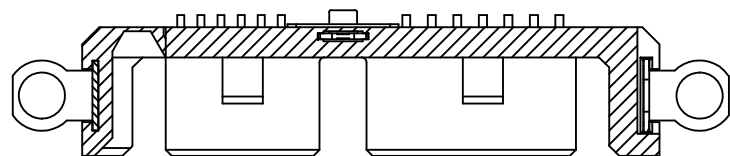

SECTION D1-D1

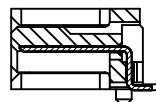

SECTION A1-A1

NOTES : OTHER DIMENSIONS AND NOTES REFER TO SHEET-1.

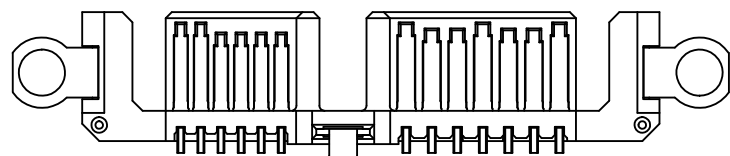
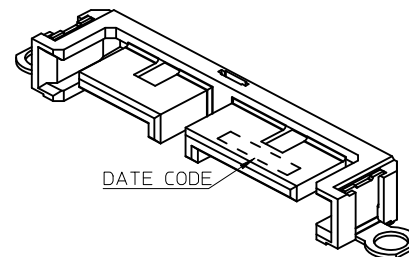
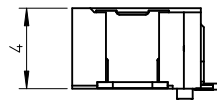
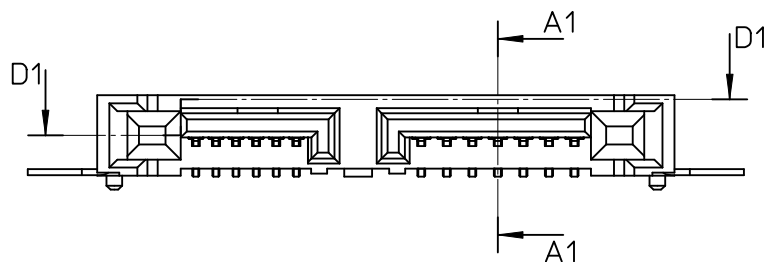

P/N	CONTACT PLATING	NAIL
47300-1014	GOLD FLASH	STAINLESS STEEL, NO PLATING
47300-1012	GOLD 0.38 MICRONS MIN	
47300-1010	GOLD 0.76 MICRONS MIN	PHOSPHOR BRONZE, MATTE TIN PLATING
47300-1015	GOLD FLASH	
47300-1013	GOLD 0.38 MICRONS MIN	
47300-1011	GOLD 0.76 MICRONS MIN	

REVISED EC NO: SH2012-0082 DRW: GLL1 CHKD: APPR: X.JSONG 2011/10/11 2011/10/14	QUALITY SYMBOLS $\nabla_F=0$ $\nabla_E=0$ $\nabla_D=0$	GENERAL TOLERANCES (UNLESS SPECIFIED)		DIMENSION STYLE MM ONLY	SCALE 4:1	DESIGN UNITS METRIC	THIRD ANGLE PROJECTION		
		4 PLACES ± --- ± --- 3 PLACES ± --- ± --- 2 PLACES ± --- ± --- 1 PLACE ± --- ± ---	mm INCH	DRAWN BY GLL1	DATE 2011/10/11	TITLE SLIMLINE SATA PLUG FOR OPTIC DISK DIVER SCREW LOW TYPE			
		ANGULAR ± 3 °		CHECKED BY	DATE	APPROVED BY			
		DRAFT WHERE APPLICABLE MUST REMAIN WITHIN DIMENSIONS		MATERIAL NO. SEE TABLE	DOCUMENT NO. SD-47300-100	SHEET NO. 2 OF 7			

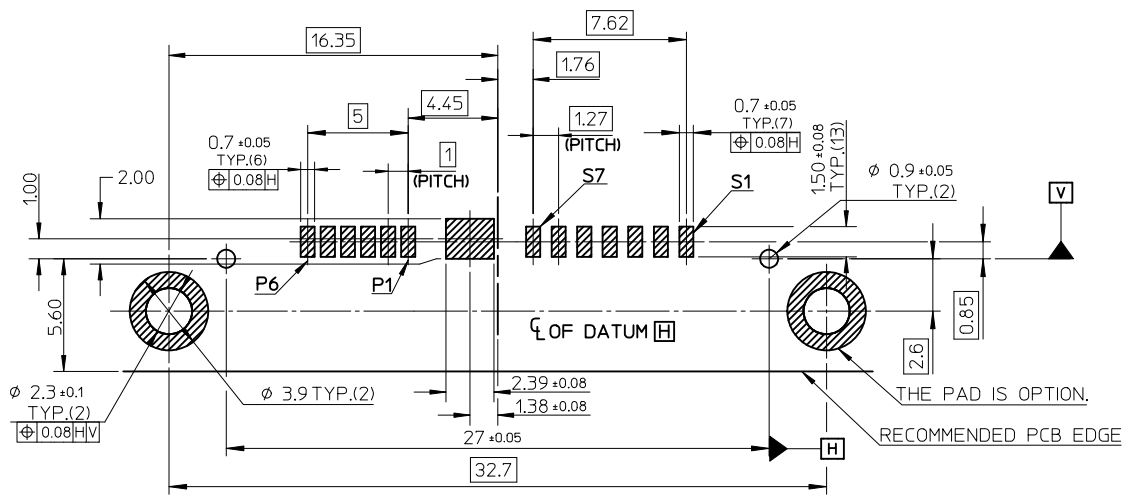

RECOMMENDED PCB LAYOUT(CONNECTOR SIDE)

THICKNESS=0.8MM

REMARK:

THE PCB LAYOUT IS ONLY FOR 47300-100X, 47300-101X.

REVISED EC NO: SH2012-0082 DRWG: GLLI CHKD: APPR: XJ.SONG 2011/10/11 2011/10/14	QUALITY SYMBOLS $\nabla = 0$ $\nabla = 0$ $\nabla = 0$	GENERAL TOLERANCES (UNLESS SPECIFIED)		DIMENSION STYLE MM ONLY	SCALE 4:1	DESIGN UNITS METRIC	THIRD ANGLE PROJECTION		
		4 PLACES ± --- ± --- 3 PLACES ± --- ± --- 2 PLACES ± --- ± --- 1 PLACE ± --- ± ---	mm INCH	DRAWN BY GLLI	DATE 2011/10/11	TITLE SLIMLINE SATA PLUG FOR OPTIC DISK DIVER SCREW TYPE			
		ANGULAR ± 3 °		CHECKED BY	DATE	APPROVED BY			
		DRAFT WHERE APPLICABLE MUST REMAIN WITHIN DIMENSIONS		MATERIAL NO. SEE REMARK		DOCUMENT NO. SD-47300-100		SHEET NO. 3 OF 7	
REV N		SIZE A3		THIS DRAWING CONTAINS INFORMATION THAT IS PROPRIETARY TO MOLEX INCORPORATED AND SHOULD NOT BE USED WITHOUT WRITTEN PERMISSION					

10 9 8 7 6 5 4 3 2 1

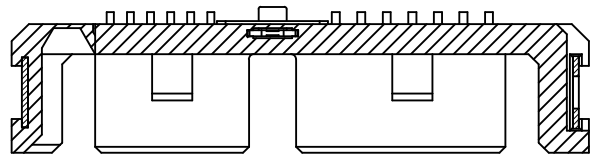

SECTION D-D

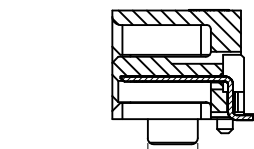

SECTION A-A
2.48 TYP.(2)

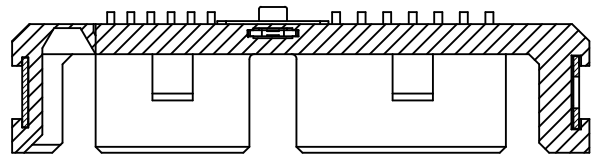

SECTION Z-Z

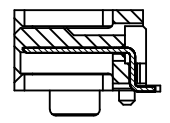

SECTION Y-Y

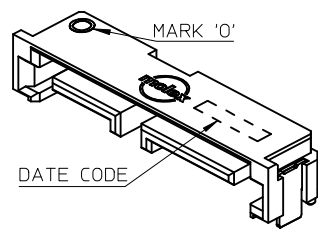
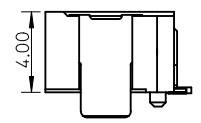
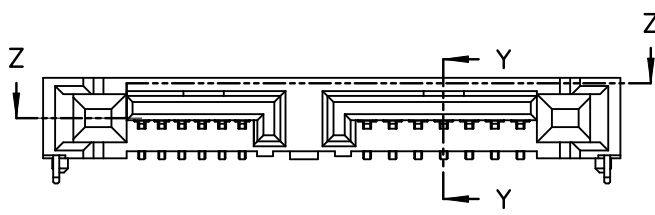
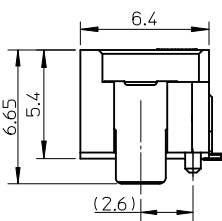
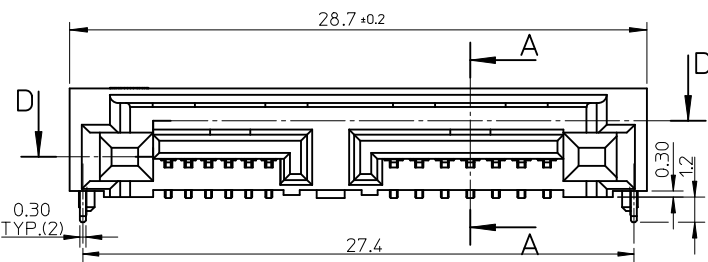

ONLY FOR 47300-1024/1025

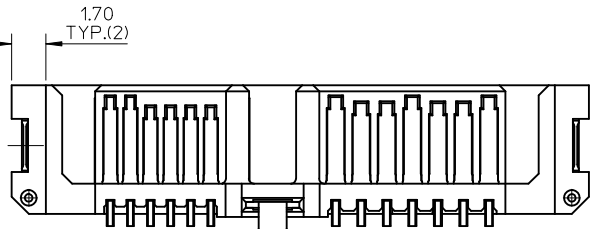
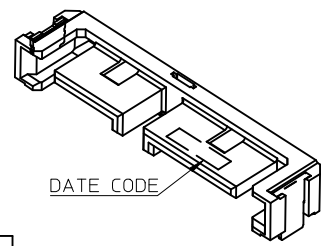
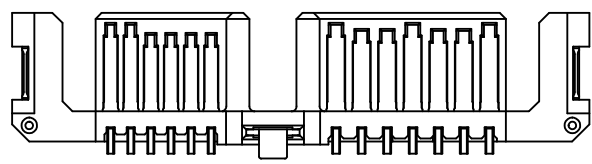

P/N	CONTACT PLATING	REMARK
47300-1026	GOLD FLASH	WITH MARK 'G'
47300-1025	GOLD 0.76 MICRONS MIN	WITH MARK 'O'
47300-1024	GOLD 0.38 MICRONS MIN	WITHOUT MARK 'O'
47300-1022	GOLD 0.76 MICRONS MIN	
47300-1021	GOLD 0.38 MICRONS MIN	
47300-1023	GOLD FLASH	
47300-1020	GOLD FLASH	

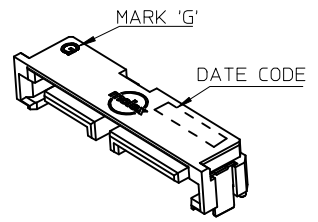

ONLY FOR 47300-1026

P/N	CONTACT PLATING
47300-1032	GOLD 0.76 MICRONS MIN
47300-1031	GOLD 0.38 MICRONS MIN
47300-1030	GOLD FLASH

NOTES : OTHER DIMENSIONS AND NOTES REFER TO 47300-102X.

- NOTES :
- MATERIAL :
SOLDERING PEG : COPPER ALLOY
 - PLATING :
SOLDERING PEG :
MATTE TIN PLATING 1.0 MICRONS MIN.
OVER NICKEL PLATING 1.0 MICRONS MIN.
 - PRODUCT PACKAGE SPEC: PK-47300-003.
 - OTHER NOTES AND DIMENSIONS REFER TO SHEET-1.

REVISED	EC NO: SH2012-0082	2011/10/11	QUALITY SYMBOLS
DRW:GLL1	CHKD:	2011/10/14	▽=0
APPR:XJ.SONG	DESCRIPTION		▽=0
REV			▽=0

GENERAL TOLERANCES (UNLESS SPECIFIED)	
	mm INCH
4 PLACES	± --- ± ---
3 PLACES	± --- ± ---
2 PLACES	± --- ± ---
1 PLACE	± --- ± ---
ANGULAR ± 3 °	
DRAFT WHERE APPLICABLE MUST REMAIN WITHIN DIMENSIONS	

DIMENSION STYLE	
MM ONLY	
DRAWN BY	DATE
GLL1	2011/10/11
CHECKED BY	DATE
APPROVED BY	DATE
MATERIAL NO.	
SEE TABLE OR NOTES	
SIZE	A3

SCALE	4:1
DESIGN UNITS	METRIC
THIRD ANGLE PROJECTION	
TITLE	
SLIMLINE SATA PLUG FOR OPTIC DISK DIVER SOLDERING STANDARD TYPE	
MOLEX INCORPORATED	
MATERIAL NO.	DOCUMENT NO.
SEE TABLE OR NOTES	SD-47300-100
THIS DRAWING CONTAINS INFORMATION THAT IS PROPRIETARY TO MOLEX INCORPORATED AND SHOULD NOT BE USED WITHOUT WRITTEN PERMISSION	

TITLE	
SLIMLINE SATA PLUG FOR OPTIC DISK DIVER SOLDERING STANDARD TYPE	
MOLEX INCORPORATED	
MATERIAL NO.	DOCUMENT NO.
SEE TABLE OR NOTES	SD-47300-100
THIS DRAWING CONTAINS INFORMATION THAT IS PROPRIETARY TO MOLEX INCORPORATED AND SHOULD NOT BE USED WITHOUT WRITTEN PERMISSION	
SHEET NO.	4 OF 7

9 8 7 6 5 4 3 2 1

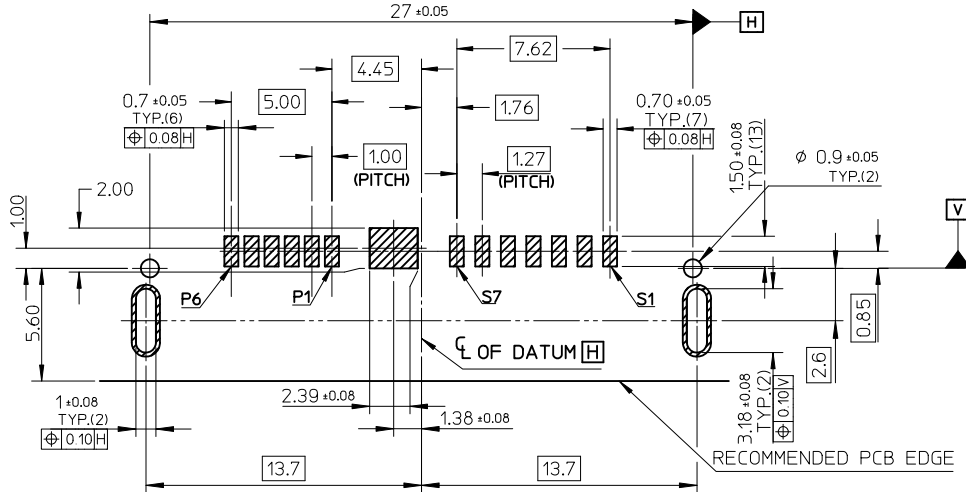

RECOMMEND PCB LAYOUT (THICKNESS=0.8)

REMARK:
THE PCB LAYOUT IS ONLY FOR 47300-102X AND 47300-103X.

REVISED EC NO: SH2012-0082 DRW: GLL1 CHKD: APPR: X.J.SONG 2011/10/11 2011/10/14	QUALITY SYMBOLS	GENERAL TOLERANCES (UNLESS SPECIFIED)		DIMENSION STYLE	SCALE	DESIGN UNITS	THIRD ANGLE PROJECTION
	▽=0	mm	INCH	MM ONLY	4:1	METRIC	
	▽=0	4 PLACES ± --- ± ---		DRAWN BY	DATE	TITLE	
	▽=0	3 PLACES ± --- ± ---		GLL1	2011/10/11	SLIMLINE SATA PLUG FOR OPTIC DISK DIVER SOLDERING TYPE	
	2 PLACES ± --- ± ---		CHECKED BY	DATE	MOLEX INCORPORATED		
	1 PLACE ± --- ± ---		APPROVED BY	DATE	MATERIAL NO. SEE REMARK		
	ANGULAR ± 3 °				DOCUMENT NO. SD-47300-100		
	DRAFT WHERE APPLICABLE MUST REMAIN WITHIN DIMENSIONS				SHEET NO. 5 OF 7		
					THIS DRAWING CONTAINS INFORMATION THAT IS PROPRIETARY TO MOLEX INCORPORATED AND SHOULD NOT BE USED WITHOUT WRITTEN PERMISSION		

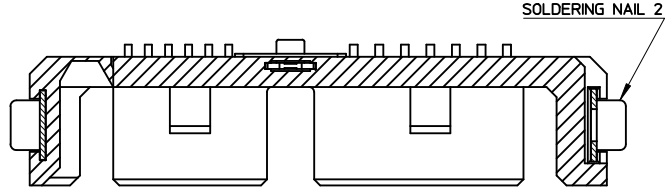

SECTION D-D

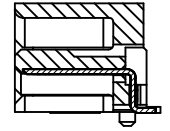

SECTION A-A

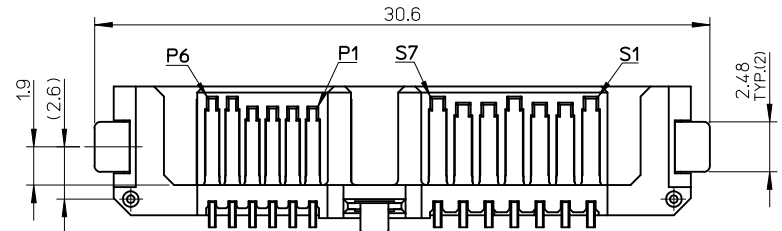
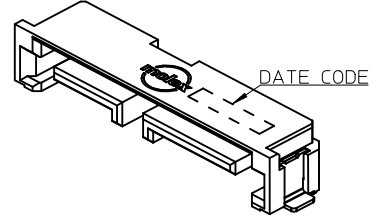
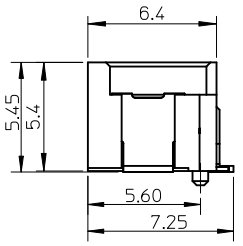
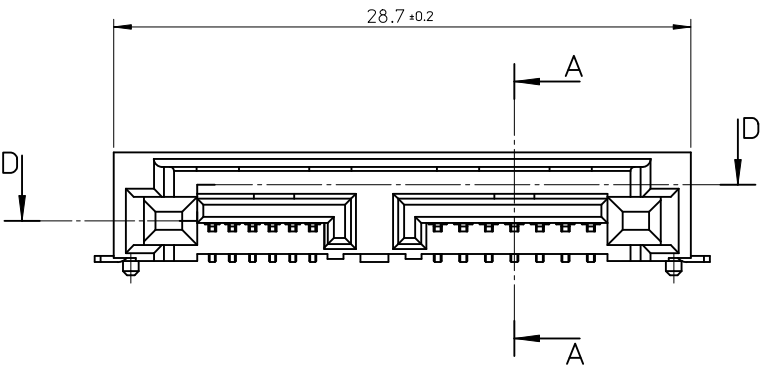

- NOTES :
- MATERIAL :
SOLDERING NAIL 2 : COPPER ALLOY
 - PLATING :
SOLDERING NAIL 2 : MATTE TIN PLATING 1.0 MICRONS MIN.
OVER NICKEL PLATING 1.0 MICRONS MIN.
 - PACKING SPEC OF 47300-1046 REFER TO PK-47300-004,
OTHER PACKING SPEC REFER TO PK-47300-001.
 - OTHER NOTES AND DIMENSIONS REFER TO SHEET-1.

P/N	CONTACT PLATING
47300-1042	GOLD 0.76 MICRONS MIN
47300-1041	GOLD 0.38 MICRONS MIN
47300-1040	GOLD FLASH
47300-1046	GOLD FLASH

REVISED EC NO: SH2012-0082 DRWN:GLL CHKD: APPR:XJSONG 2011/10/11 2011/10/14	DESCRIPTION QUALITY SYMBOLS $\nabla_{\text{A}}=0$ $\nabla_{\text{C}}=0$ $\nabla_{\text{P}}=0$	GENERAL TOLERANCES (UNLESS SPECIFIED)		DIMENSION STYLE MM ONLY	SCALE 4:1	DESIGN UNITS METRIC	THIRD ANGLE PROJECTION		
		4 PLACES ± --- ± --- 3 PLACES ± --- ± --- 2 PLACES ± --- ± --- 1 PLACE ± --- ± ---	mm INCH	DRAWN BY GLL I	DATE 2011/10/11	TITLE SLIMLINE SATA PLUG FOR OPTIC DISK DIVER FITTING STANDARD TYPE			
		ANGULAR ± 3 °		CHECKED BY	DATE	APPROVED BY			
		DRAFT WHERE APPLICABLE MUST REMAIN WITHIN DIMENSIONS		MATERIAL NO. SEE TABLE	DATE	DOCUMENT NO. SD-47300-100		SHEET NO. 6 OF 7	
SIZE A3		THIS DRAWING CONTAINS INFORMATION THAT IS PROPRIETARY TO MOLEX INCORPORATED AND SHOULD NOT BE USED WITHOUT WRITTEN PERMISSION							

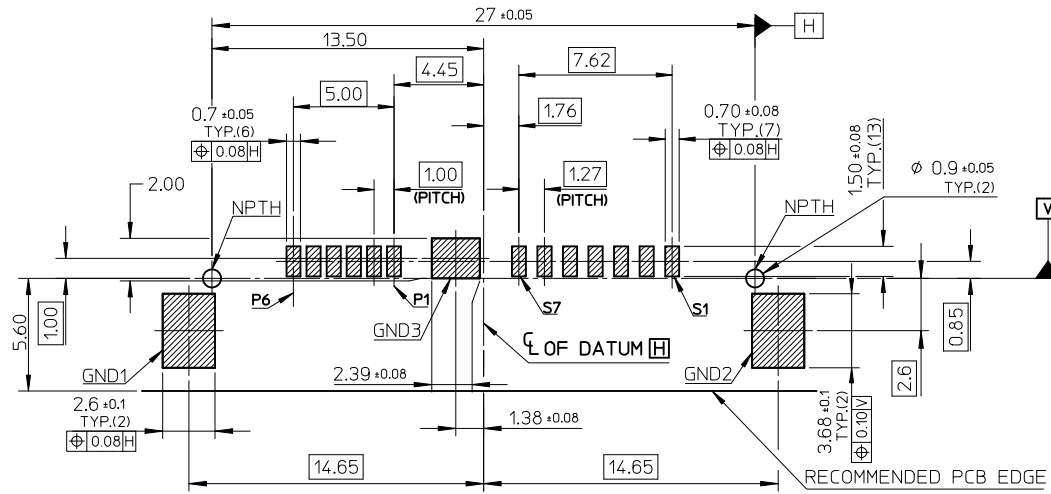

RECOMMEND PCB LAYOUT

REMARK:
THE PCB LAYOUT IS ONLY FOR 47300-104X

REVISED IEC NO: SH2012-0082 DRWNG: GLL1 CHYKD: APPR: X.J.SONG 2011/10/11 2011/10/14	QUALITY SYMBOLS	GENERAL TOLERANCES (UNLESS SPECIFIED)		DIMENSION STYLE	SCALE	DESIGN UNITS	THIRD ANGLE PROJECTION
	$\nabla_F = 0$ $\nabla_E = 0$ $\nabla_A = 0$	4 PLACES ± --- ± --- 3 PLACES ± --- ± --- 2 PLACES ± --- ± --- 1 PLACE ± --- ± ---	mm INCH ± --- ± --- ± --- ± --- ± --- ± ---	MM ONLY DRAWN BY: GLL1 DATE: 2011/10/11 CHECKED BY: DATE: APPROVED BY: DATE:	4:1	METRIC	TITLE: SLIMLINE SATA PLUG FOR OPTIC DISK DIVER FITTING TYPE MOLEX MOLEX INCORPORATED
		ANGULAR ± 3 °		MATERIAL NO. SEE REMARK SIZE: A3 THIS DRAWING CONTAINS INFORMATION THAT IS PROPRIETARY TO MOLEX INCORPORATED AND SHOULD NOT BE USED WITHOUT WRITTEN PERMISSION			DOCUMENT NO. SD-47300-100 SHEET NO. 7 OF 7
		DRAFT WHERE APPLICABLE MUST REMAIN WITHIN DIMENSIONS					