

PANEL THICKNESS	X
0.75-1.25	19.2 -0.1
1.25-2.0	19.4 -0.1
2.0-3.0	19.8 -0.1

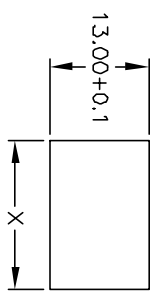

PANEL CUTOUT

SWITCH FUNCTION			
POS. 1	POS. 2	POS. 3	
DN	NONE	DN	
1a-1	DPEN	1-1b	

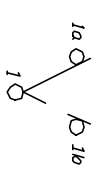

CIRCUIT: SPDT

NOTES:

1. ALL DIMENSIONS IN MM
2. GENERAL TOLERANCE: X.X=±0.4  
X.XX=±0.25
3. TERMINAL NUMBERS FOR REF ONLY.
4. RATING: 15A @ 125VAC OR 6A @ 250VAC
5. MECHANICAL LIFE: 15,000 cycles
6. ELECTRICAL LIFE: 10,000 cycles
7. INSULATION RESISTANCE: >1000 Mega Ω
8. CONTACT RESISTANCE: <20 Mega Ω
9. DIELECTRIC STRENGTH: >1500 V 1 minute  
>3000 V between poles

**E-SWITCH®**

REV. B		11502		REVISED AND REDRAWN		5/21/01		CJB		TITLE	
ECN No.		DESCRIPTION		DATE		CHKD		SCALE		DATE	
11502		REVISOR		5/21/01		CJB		1:5:1		12/06/00	
DR		DVG		M302201		REV		B			
PML											

THE INFORMATION CONTAINED IN THIS DOCUMENT IS PROPRIETARY TO E-SWITCH AND IS NOT TO BE COPIED OR TRANSMITTED