

REV.	DATE	DESCRIPTION
NC	09/25/06	INITIAL RELEASE

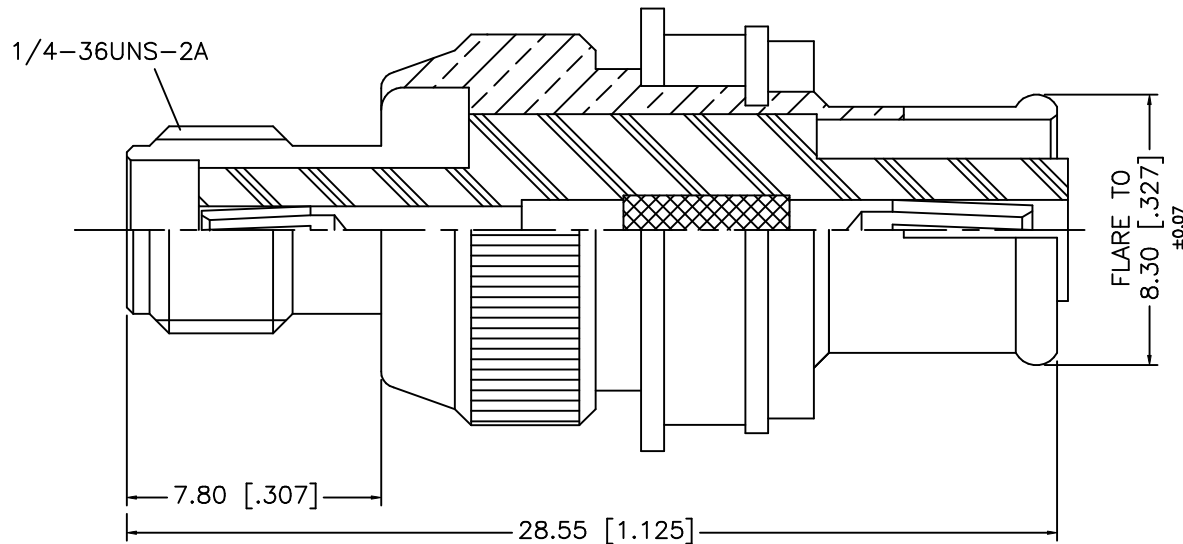

REV.	DATE	DESCRIPTION
NC	09/25/06	INITIAL RELEASE
8		
7	GASKET	RUBBER RED 1
6	RETAINING RING	BRASS NICKEL 1
5	RING	DELRIN NATURAL 1
4	WASHER	BRASS NICKEL 1
3	CONTACT PIN	PHOS. BRONZE GOLD 1
2	INSULATOR	TEFLON NATURAL 1
1	BODY	BRASS NICKEL 1
	DESCRIPTION	MATERIAL FINISH QTY

UNLESS OTHERWISE SPECIFIED DIMENSIONS ARE IN MILLIMETERS. DIMENSIONS IN [] ARE IN INCHES AND FOR CUSTOMER REFERENCE ONLY.		APPROVALS	DATE
UNLESS OTHERWISE SPECIFIED TOLERANCES FOR MILLIMETERS ARE: 0.5 - 8mm ± 0.20mm 8 - 30mm ± 0.40mm 30 - 120mm ± 0.50mm		DRAWN G.R.S.	09/25/06
UNLESS OTHERWISE SPECIFIED TOLERANCES FOR INCHES ARE: .020 - .315 = ± 0.007" .315 - 1.180 = ± 0.015" 1.180 - 4.724 = ± 0.020"		CHECKED	
DO NOT SCALE DRAWING		ISSUED	
		SHEET 1 OF 1	
		CAD FILE C:/242/242105RP-10.DWG	

Amphenol Connex			
PART DESCRIPTION SMA JACK TO TNC REVERSE POLARITY JACK ADAPTER			
PART NO. 242105RP-10			
DWG. NO.	242105RP-10.DWG	REV. NC	SCALE NA