

# Customer Information Sheet

DRAWING No.: P25-XX26

SHEET 2 OF 2

IF IN DOUBT - ASK

©

NOT TO SCALE

THIRD ANGLE PROJECTION

ALL DIMENSIONS IN mm

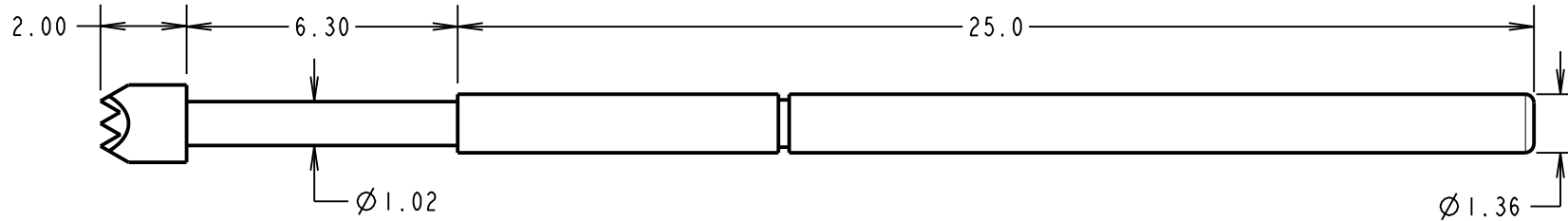

ORDER CODE:  
**P25-XX26**  
PROBE HEAD  
VARIANT (SEE BELOW)

- NOTES:  
1. TO BE USED WITH SLEEVE S25-XX6.  
2. SUITABLE FOR A MINIMUM DISTANCE BETWEEN CENTRES OF 2.54mm.

PROBE HEAD VARIANTS	
 SPEAR HEAD P25-0126	 CROWN HEAD P25-3226
 TULIP HEAD P25-1726	 SERRATED HEAD P25-4026

SPECIFICATIONS:  
 MATERIAL:  
 PLUNGER = BERYLLIUM COPPER  
 BARREL = PHOSPHOR BRONZE  
 SPRING = MUSIC WIRE  
 FINISH:  
 PLUNGER, BARREL AND SPRING = GOLD OVER NICKEL  
 ELECTRICAL:  
 CURRENT RATING = 3A  
 CONTACT RESISTANCE = 30 MILLIOHMS  
 MECHANICAL:  
 DURABILITY = 1,000,000 CYCLES  
 FULL TRAVEL = 6.30mm  
 SPRING FORCES:  
 AT FULL TRAVEL = 3.43N±0.69N (350g ±20%)  
 AT 2/3 TRAVEL = 2.26N ±0.45N (230g ±20%)  
 ENVIRONMENTAL:  
 TEMPERATURE RANGE = -40°C TO +85°C

SM	5	16.03.11	11173
NAME	ISS.	DATE	C/NOTE
APPROVED: S. MCCULLAGH			
CHECKED:		R. ADDE	
DRAWN:		W. J. BOURNE	
CUSTOMER REF.:			
ASSEMBLY DRG:			

**HARWIN**

HARWIN USA TEL: 603 893 5376 FAX: 603 893 5396 mis@harwin.com	HARWIN Europe (UK) TEL: 023 9231 4545 FAX: 023 9231 4590 mis@harwin.co.uk	HARWIN Asia TEL: +65 6 779 4909 FAX: +65 6 779 3868 mis@harwin.com.sg
--	--	--

THIS DRAWING AND ANY INFORMATION OR DESCRIPTIVE MATTER SET OUT HEREON ARE CONFIDENTIAL AND COPYRIGHT PROPERTY OF THE HARWIN GROUP AND MUST NOT BE DISCLOSED, LOANED, COPIED OR USED FOR MANUFACTURING, TENDERING OR FOR ANY OTHER PURPOSE WITHOUT THEIR WRITTEN PERMISSION.

TOLERANCES  
 X. = ±1mm  
 X.X = ±0.25mm  
 X.XX = ±0.10mm  
 X.XXX = ±0.01mm  
 ANGLES = ±5°  
 UNLESS STATED

MATERIAL:  
 SEE ABOVE  
 FINISH: SEE ABOVE  
 S/AREA: mm<sup>2</sup>

TITLE:  
 2.54mm MIN. CENTRE  
 TWO-PIECE SPRING PROBE  
 DRAWING NUMBER:  
**P25-XX26**

SHT  
2 OF 2